

From: Sharpe Doreen [Doreen.Sharpe@dnrm.qld.gov.au]

Sent: Monday, 17 February 2014 10:11 AM

To: property@energex.com.au; property@urbanutilities.com.au; F0501488@team.telstra.com; info@nationaltrail.com.au; propsearch@powerlink.com.au; RPF.CMU@tmr.qld.gov.au; metropolitanregion@tmr.qld.gov.au

Subject: FW: Application for Permanent Road Closure - The Unnamed Road off East Egypt Road, Egypt & Flagstone Creek

Attachments: SKMBT_C451 14021709490.pdf

Our Ref: 2014/000409

Hello

Please find enclosed a copy of the Notice published in the Government Gazette of 14 February 2014 and drawing DWG 14/025 relative to the above application.

The applicant advises that the proposed use of the subject area, if the road closure is approved would be fire break and buffer zone purposes as part of a property bush fire management plan

To enable full consideration to be given to this matter please submit your views and/or requirements, in writing, to this office by 27 March 2014. If no reply is received by that date it will be assumed you have no objection to the application.

Any objections received may be viewed by other parties interested in the proposed road closure in accordance with the provisions of the *Right to Information Act 2009*.

If you wish to discuss this matter please contact Doreen Sharpe on 07 3884 5346.

All future correspondence relative to this matter is to be referred to the contact an Officer at the address below or by email to slam-ipswich@derm.qld.gov.au. Any hard copy correspondence received will be electronically scanned and filed. For this reason, it is recommended that any attached plans, sketches or maps be no larger than A3-sized.

Please quote reference number 2014/000409 in any future correspondence.

Regards

Doreen Sharpe
Land Officer, Land Management, Ipswich
Department of Natural Resources and Mines
Telephone: 3884 5346 **Fax:** 3884 5396
Email: doreen.sharpe@dnrm.qld.gov.au

PO Box 864, Ipswich Q 4305
Level 1, 114 Brisbane Street, Ipswich

DRAWING

| | |
|-------|----|
| Sheet | of |
| 1 | 1 |



159
CC1070

104
SPI44471

Locality of Flagstone Creek

**Road Proposed To Be
Permanently Closed**

abt 2.3 ha

2
RP108549

1
RP108549

96
CC142

Locality of Egypt

161
CC677

105
CC206

162
CP846036

162
CP846036

162
CP846036



Scale - 1:5000

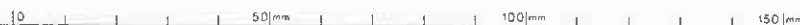

Prepared by
IPSWICH OFFICE
RESOURCE ASSESSMENT
and INFORMATION
SOUTH REGION
DEPT OF NATURAL RESOURCES
and MINES
LEVEL 1
TOWER CENTRAL
IPSWICH Q 4305

ROAD PROPOSED TO BE PERMANENTLY CLOSED



PROPOSAL

Scale 1 : 5000
Plan at A3 Paper Size

PARISH : CAMPBELL
EGYPT &
LOCALITY : FLAGSTONE CREEK

COUNTY CHURCHILL
REGIONAL COUNCIL OF
LOCAL AUTH : LOCKYER VALLEY

DWG 14/025

Compiled from DCDB & Sketch on File

Drawn by JKN

File Ref Case Id 2014/000409

Map Ref 9342 - 43124

Date 29/01/2014

© The State of Queensland (Dept of Natural Resources & Mines) 2014
Base date extracted from the Digital Cadastral Database on the 29/01/2014

*Land Act 1994***OBJECTIONS TO PROPOSED ROAD CLOSURE NOTICE
(No 06) 2014****Short title**

1. This notice may be cited as the *Objections to Proposed Road Closure Notice (No 06) 2014*.

Application for road closure [s.100 of the Act]

2. Applications have been made for the permanent closure of the roads mentioned in the Schedule.

Objections

3.(1) An objection (in writing) to a proposed road closure mentioned in the Schedule may be lodged with the Regional Service Director, Department of Natural Resources and Mines, at the regional office for the region in which the road is situated.

(2) Latest day for lodgement of objections is **27 March 2014**.

(3) Any objections received may be viewed by other parties interested in the proposed road closure under the provisions of the *Right to Information Act 2009*. If you lodge an objection, please include in your objection letter whether you would like to be consulted if this issue becomes the subject of an access request under the *Right to Information Act 2009*.

Plans

4. Inspection of the plans of the proposed road closures may be made at-

- (a) the Department of Natural Resources and Mines Offices at Ipswich and Nambour; and
- (b) the Local Government Offices of Lockyer Valley Regional and Noosa Shire;

for a particular plan in that district or that local government area.

SCHEDULE**PERMANENT CLOSURE****South Region, Ipswich Office**

1 An area of about 2.3 ha being part of the unnamed road off East Egypt Road abutting Lots 1 and 2 on RP108549 (parish of Campbell, localities of Egypt and Flagstone Creek) and shown as road proposed to be permanently closed on Drawing 14/025. (2014/000409)

South Region, Nambour Office

*2 An area of about 1.14 ha being part of the unnamed road intersecting Lot 21 on NPW1150 (parish of Laguna, locality of Noosa North Shore) and shown as road proposed to be permanently closed on Drawing 13/073. (2012/004842)

*The proposed closure of this road is in conjunction with the proposed opening of another road.

ENDNOTES

1. Published in the Gazette on 14 February 2014.
2. Not required to be laid before the Legislative Assembly.
3. The administering agency is the Department of Natural Resources and Mines.

Gov. Gaz., 14 February 2014, No. 28 page 137

Brisbane

© The State of Queensland 2014

From: Sharpe Doreen [Doreen.Sharpe@dnrm.qld.gov.au]

Sent: Monday, 17 February 2014 10:12 AM

To: mail@lvrc.qld.gov.au

Subject: Application for Permanent Road Closure - part of the Unnamed Road Off East Egypt Road, Flagstone Creek

Attachments: SKMBT_C451 14021709490.pdf

Our Ref: 2014/000409

Hello

Please find enclosed a copy of the Notice published in the Government Gazette of 14 February 2014 and drawing DWG 14/025 relative to the above application.

You are requested to display the notice at your office for the purpose of being viewed by the public in terms of Section 100 of the *Land Act 1994*. Your views and/or requirements are also requested in respect of the application.

The applicant advises that the proposed use of the subject areas, if the road closure is approved would be for fire break and buffer zone purposes as part of a property bush fire management plan.

Could Council please advise the Department of it's views or requirements to the application, that the department should consider when assessing this application:

Objections to the application, and any views or requirements that may affect the future use of the land should be received by close of business on 27 March 2014. If you offer an objection to the application, a full explanation stating the reason for such an object should be forwarded to this Office.

If you wish to provide a response but are unable to do so before the due date, please contact the author before the due date to arrange a more suitable timeframe. If a response is not received by the due date and no alternative arrangements have been made, it will be assumed you have no objections or requirements in relation to this matter.

This information has been provided to you in confidence for the purpose of seeking your views on this matter. It is not to be used for any other purpose, or distributed further to any person, company, or organisation, without the express written permission of the department unless required.

Any objections received may be viewed by other parties interested in the proposed road closure in accordance with the provisions of the *Right to Information Act 2009*.

If you wish to discuss this matter please contact Doreen Sharpe on 07 3884 5346.

All future correspondence relative to this matter is to be referred to the contact Officer at the address below or by email to slam-ipswich@dnrm.qld.gov.au. Any hard copy correspondence received will be electronically scanned and filed. For this reason, it is recommended that any attached plans, sketches or maps be no larger than A3-sized.

Please quote reference number 2014/000409 in any future correspondence.

Regards

Doreen Sharpe

Land Officer, Land Management, Ipswich

Department of Natural Resources and Mines

Telephone: 3884 5346 **Fax:** 3884 5396

Email: doreen.sharpe@dnrm.qld.gov.au

PO Box 864, Ipswich Q 4305

Level 1, 114 Brisbane Street, Ipswich

DRAWING

Sheet 1 of 1



159
CC1070

104
SPI44471

Locality of Flagstone Creek

**Road Proposed To Be
Permanently Closed**

abt 2.3 ha

2
RP108549

1
RP108549

96
CC142

Locality of Egypt

161
CC677

105
CC206

162
CP846036

162
CP846036

162
CP846036



Prepared by
IPSWICH OFFICE
RESOURCE ASSESSMENT
and INFORMATION
SOUTH REGION
DEPT OF NATURAL RESOURCES
and MINES
LEVEL 1
TOWER CENTRAL
IPSWICH Q 4305

ROAD PROPOSED TO BE PERMANENTLY CLOSED



PROPOSAL

Scale 1 : 5000
Plan at A3 Paper Size

PARISH : CAMPBELL COUNTY CHURCHILL
EGYPT & REGIONAL COUNCIL OF
LOCALITY : FLAGSTONE CREEK LOCAL AUTH : LOCKYER VALLEY

DWG 14/025

Compiled from DCDB & Sketch on File Drawn by JKN
File Ref Case Id 2014/000409 Map Ref 9342 - 43124 Date 29/01/2014

© The State of Queensland (Dept of Natural Resources & Mines) 2014
Base date extracted from the Digital Cadastral Database on the 29/01/2014

*Land Act 1994***OBJECTIONS TO PROPOSED ROAD CLOSURE NOTICE
(No 06) 2014****Short title**

1. This notice may be cited as the *Objections to Proposed Road Closure Notice (No 06) 2014*.

Application for road closure [s.100 of the Act]

2. Applications have been made for the permanent closure of the roads mentioned in the Schedule.

Objections

3.(1) An objection (in writing) to a proposed road closure mentioned in the Schedule may be lodged with the Regional Service Director, Department of Natural Resources and Mines, at the regional office for the region in which the road is situated.

(2) Latest day for lodgement of objections is **27 March 2014**.

(3) Any objections received may be viewed by other parties interested in the proposed road closure under the provisions of the *Right to Information Act 2009*. If you lodge an objection, please include in your objection letter whether you would like to be consulted if this issue becomes the subject of an access request under the *Right to Information Act 2009*.

Plans

4. Inspection of the plans of the proposed road closures may be made at-

- (a) the Department of Natural Resources and Mines Offices at Ipswich and Nambour; and
- (b) the Local Government Offices of Lockyer Valley Regional and Noosa Shire;

for a particular plan in that district or that local government area.

SCHEDULE**PERMANENT CLOSURE****South Region, Ipswich Office**

1 An area of about 2.3 ha being part of the unnamed road off East Egypt Road abutting Lots 1 and 2 on RP108549 (parish of Campbell, localities of Egypt and Flagstone Creek) and shown as road proposed to be permanently closed on Drawing 14/025. (2014/000409)

South Region, Nambour Office

*2 An area of about 1.14 ha being part of the unnamed road intersecting Lot 21 on NPW1150 (parish of Laguna, locality of Noosa North Shore) and shown as road proposed to be permanently closed on Drawing 13/073. (2012/004842)

*The proposed closure of this road is in conjunction with the proposed opening of another road.

ENDNOTES

1. Published in the Gazette on 14 February 2014.
2. Not required to be laid before the Legislative Assembly.
3. The administering agency is the Department of Natural Resources and Mines.

Gov. Gaz., 14 February 2014, No. 28 page 137

Brisbane

© The State of Queensland 2014

DRAWING

Sheet 1 of 1



159
CC1070

104
SPI44471

Locality of Flagstone Creek

**Road Proposed To Be
Permanently Closed**

abt 2.3 ha

2
RP108549

1
RP108549

96
CC142

Locality of Egypt

161
CC677

105
CC206

162
CP846036

162
CP846036

162
CP846036



Scale - 1:5000



Prepared by
IPSWICH OFFICE
RESOURCE ASSESSMENT
and INFORMATION
SOUTH REGION
DEPT OF NATURAL RESOURCES
and MINES
LEVEL 1
TOWER CENTRAL
IPSWICH Q 4305

ROAD PROPOSED TO BE PERMANENTLY CLOSED



PROPOSAL

Scale 1 : 5000
Plan at A3 Paper Size

PARISH : CAMPBELL
EGYPT &
LOCALITY : FLAGSTONE CREEK

COUNTY CHURCHILL
REGIONAL COUNCIL OF
LOCAL AUTH : LOCKYER VALLEY

DWG 14/025

Compiled from DCDB & Sketch on File

Drawn by JKN

File Ref Case Id 2014/000409

Map Ref 9342 - 43124

Date 29/01/2014

© The State of Queensland (Dept of Natural Resources & Mines) 2014
Base date extracted from the Digital Cadastral Database on the 29/01/2014

From: Sharpe Doreen [Doreen.Sharpe@dnrm.qld.gov.au]
Sent: Tuesday, 18 February 2014 4:49 PM
To: 'Lockyer Electorate Office'
Subject: RE: Member for Lockyer - Application for Permanent Road Closure - 2014/000409
Attachments: smartmap.pdf; plan CC150.pdf

Hello Mr Rickuss

Thank you for your email below. The information will be considered as part of the Department's investigation of the application. You will be advised of the outcome when the investigations are complete.

As shown on the attached cadastre map, dedicated through access to lot 159 on CC1070 is not shown. This also affects the parcels to the south of lot 159.

However, the attached survey plan CC150 shows a dedicated road through lot 93 on CC150 (the adjoining parcel to lot 159 on CC1070) which links to the dedicated road through lot 159 on CC1070.

This means that lot 159 on CC1070 and the parcels to the south have dedicated road access through to Duncans Road.

In light of this, the matter of secondary dedicated access to lot 159 on CC1070 is currently being assessed further.

Regards

Doreen Sharpe
Land Officer, Land Management, Ipswich
Department of Natural Resources and Mines
Telephone: 3884 5346 **Fax:** 3884 5396
Email: doreen.sharpe@dnrm.qld.gov.au

PO Box 864, Ipswich Q 4305
Level 1, 114 Brisbane Street, Ipswich

From: Lockyer Electorate Office [mailto:LOCKYER@parliament.qld.gov.au]
Sent: Tuesday, 18 February 2014 3:35 PM
To: SLAM - Ipswich
Subject: Member for Lockyer - Application for Permanent Road Closure - 2014/000409

Attention: Ken Sherwood

I refer to the letter dated 17 February 2014 from the Senior Land Officer, South Region, Department of Natural Resources and Mines, in relation to an application for the permanent closure of a road, localities of Egypt and Flagstone Creek, for fire break and buffer zone purposes as part of a property bush fire management plan.

As discussed this afternoon with one of your departmental officers, I do not support this closure as it appears that Block 159 CC1070 would not have access if permanent road closure was approved.

I am sure arrangements can be made with the local council and the Department of Natural Resources and Mines so that the

bush fire management can be implemented on the gazetted road.

Please do not hesitate to contact me if you wish to discuss this matter further.

Regards

Ian Rickuss MP

Member for Lockyer

Ph: (07) 5462 2772

1800 817 791

Fax: (07) 5462 2388

Consider the environment before you print this email.

NOTICE - This e-mail and any attachments are confidential and only for the use of the addressee.

If you have received this e-mail in error, you are strictly prohibited from using, forwarding, printing, copying or dealing in anyway whatsoever with it, and are requested to reply immediately by e-mail to the sender or by telephone to the Parliamentary Service on +61 7 3406 7111.

Any views expressed in this e-mail are the author's, except where the e-mail makes it clear otherwise. The unauthorised publication of an e-mail and any attachments generated for the official functions of the Parliamentary Service, the Legislative Assembly, its Committees or Members may constitute a contempt of the Queensland Parliament. If the information contained in this e-mail and any attachments becomes the subject of any request under freedom of information legislation, the author or the Parliamentary Service should be notified.

It is the addressee's responsibility to scan this message for viruses. The Parliamentary Service does not warrant that the information is free from any virus, defect or error.

DNRM RTI DL Release

Reference to Traverse and Road Sections.

| Line | Bearing | Dist |
|-------|---------|-------|
| 1-1 | 172°16' | 105 |
| 2-1 | 175°40' | 101.7 |
| 3-1 | 175°25' | 100 |
| 4-1 | 102°34' | 106.6 |
| 11-11 | 143°22' | 100 |
| 13-13 | 125° | 100.4 |
| 14-14 | 193° | 101 |
| 16-16 | 193° | 101 |
| 18-18 | 175°35' | 106.7 |
| 7-8 | 221°20' | 143.2 |
| 8-9 | 234°24' | 612.8 |

Particulars

| No | Dist | Form | Surveyor | Dist | Remarks |
|-----|------|---------|-----------------|--------|---------------|
| 2 | | AF 51/6 | William Scanlan | 1872.3 | and |
| 93v | | AKS083 | Richard Smith | 6.5 | 108.10780 pl. |

Date of Instructions 17th Oct. 01 27th Aug. 02
 Date of transmission of plans to 27th Nov. 02
 Examined and Certified (S. C. J. S. 10)
 Voucher No. 7544 Passed for payment 06/11/02 at 1/2000
 Sales Register Vol. 10 Fol. 37
 Scale 10 Chains to an Inch.

Reference to Corners

| Corner | From | Kind | Mark |
|--------|-------|------------|------|
| 1 | 1856 | Scrub | 27 |
| 2 | | Fence Post | A 30 |
| 3 | 1857 | Scrub | 14 |
| 4 | 4050 | Base of | 18 |
| 5 | | Fence Post | 2 |
| 6 | | Post | |
| 7 | 266 | Scrub | 261 |
| 8 | | Post | |
| 9 | 8418 | Oak | 15 |
| 10 | | Fence Post | |
| 11 | | Post | |
| 12 | 1236 | Base of | 44 |
| 13 | 1376 | Scrub | 30 |
| 14 | 7036 | | 28.2 |
| 15 | 14156 | Iron nail | 40 |
| 16 | 7440 | Scrub | 38 |
| 17 | 16243 | Iron nail | 42 |
| 18 | 12440 | Scrub | 44 |
| 19 | 12440 | Scrub | 44 |
| 20 | 12440 | Scrub | 44 |
| 21 | 12440 | Scrub | 44 |
| 22 | 12440 | Scrub | 44 |
| 23 | 12440 | Scrub | 44 |
| 24 | 12440 | Scrub | 44 |
| 25 | 12440 | Scrub | 44 |
| 26 | 12440 | Scrub | 44 |
| 27 | 12440 | Scrub | 44 |
| 28 | 12440 | Scrub | 44 |
| 29 | 12440 | Scrub | 44 |
| 30 | 12440 | Scrub | 44 |



Parish of

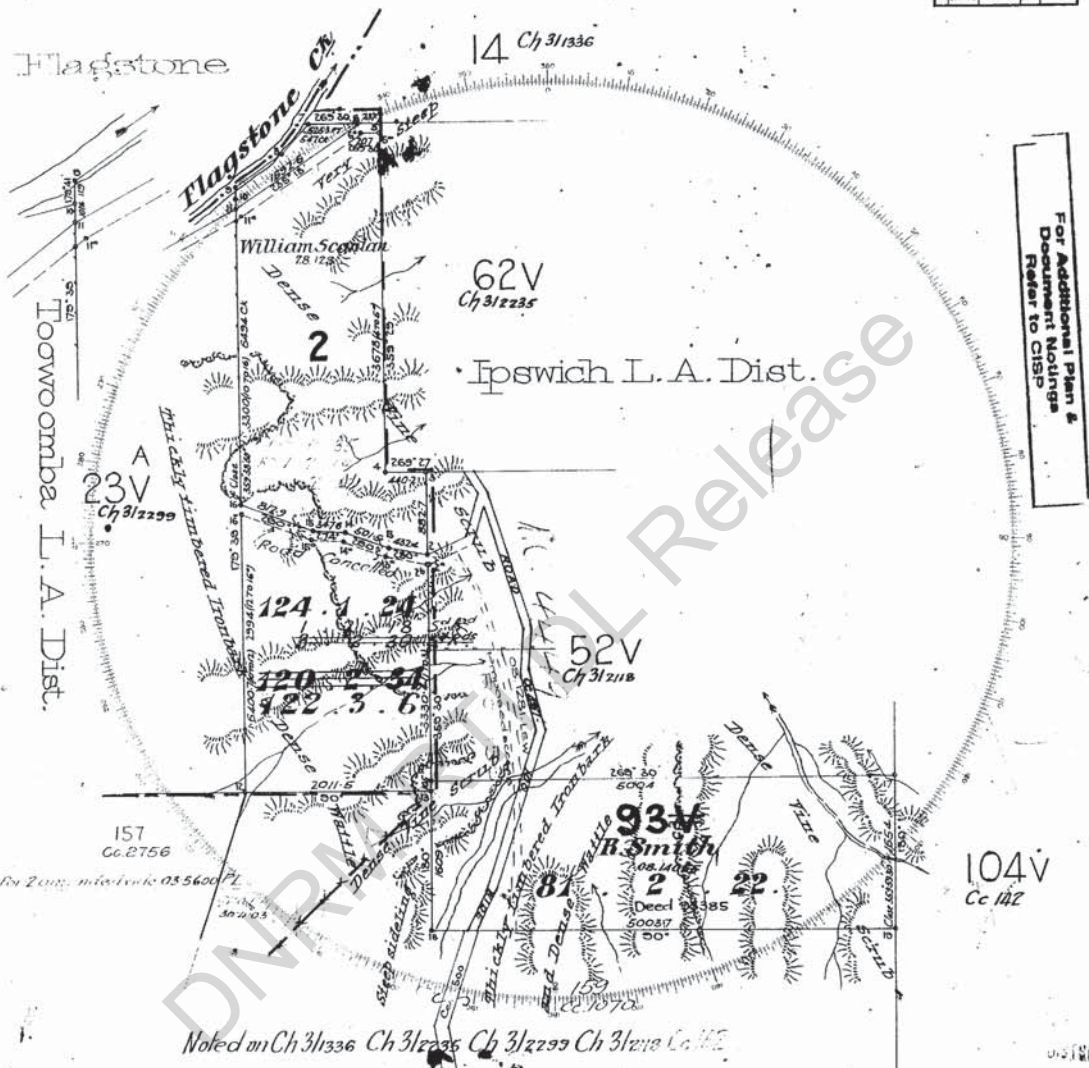

For Additional Plan & Document Notings Refer to CISP

DESCRIPTIONS AS INDICATED HEREON HAVE BEEN CONVERTED TO LOT(S) ON PLAN ... CC. 150.
 Authored: R. Watson Senior Draftsman
 Date 09/04/00

Arbitrary Meridian

I hereby certify that I in person made and on the 26th Oct. 1902 completed the survey represented by this plan, in which are shown the bearings and lengths of the lines surveyed by me, and that the survey has been executed in accordance with the acts or regulations of the Surveyor General's Department.
 Wm. Scanlan
 Surveyor

Meridian Observations (This form can also be adapted to stellar observations)

| No. | Date | Lat. | Long. | Time | Baromet. | Therm. | Wind | Remarks |
|-----|------|------|-------|------|----------|--------|------|---------|
| | | | | | | | | |
| | | | | | | | | |
| | | | | | | | | |
| | | | | | | | | |
| | | | | | | | | |

NOTE: Observing stations are shown by a triangle in red.

PLAN OF
 PORTION No 2 x 93V
 PARISH OF Campbell
 County of Churchill
 Land Agents Ipswich 93V
 District of Toowoomba 2
 Cat. No CC 150

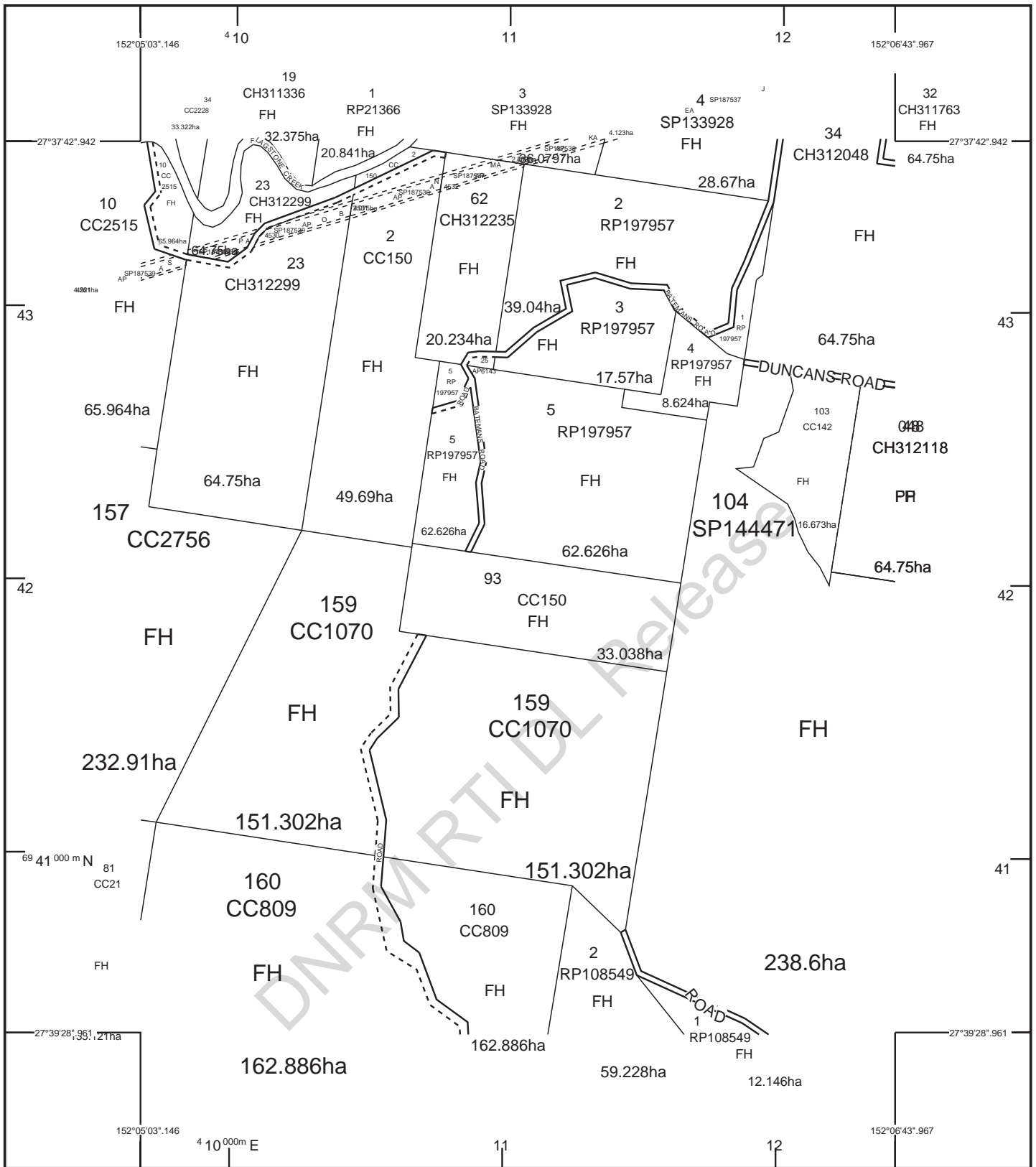

STANDARD MAP NUMBER
9342-43113



MAP WINDOW POSITION & NEAREST LOCATION



SUBJECT PARCEL DESCRIPTION

| | |
|------------------|-----------------------|
| DCDB | No Lot/Plan Selected. |
| Lot/Plan | No Lot/Plan Selected. |
| Area/Volume | No Lot/Plan Selected. |
| Tenure | No Lot/Plan Selected. |
| Local Government | No Lot/Plan Selected. |
| Locality | No Lot/Plan Selected. |
| Parish | No Lot/Plan Selected. |
| County | No Lot/Plan Selected. |
| Segment/Parcel | No Lot/Plan Selected. |

CLIENT SERVICE STANDARDS

PRINTED (dd/mm/yyyy) 18/02/2014

DCDB 17/02/2014 (Lots with an area less than 3000m² are not shown)

Users of the information recorded in this document (the Information) accept all responsibility and risk associated with the use of the Information and should seek independent professional advice in relation to dealings with property.

Despite Department of Natural Resources and Mines(DNRM)'s best efforts, DNRM makes no representations or warranties in relation to the Information, and, to the extent permitted by law, exclude or limit all warranties relating to correctness, accuracy, reliability, completeness or currency and all liability for any direct, indirect and consequential costs, losses, damages and expenses incurred in any way (including but not limited to that arising from negligence) in connection with any use of or reliance on the Information

For further information on SmartMap products visit <http://nrw.qld.gov.au/property/mapping/blinmap>

SmartMap

An External Product of SmartMap Information Services

Based upon an extraction from the Digital Cadastral Data Base



(c) The State of Queensland, (Department of Natural Resources and Mines) 2014.



From: Sheryl.P.Zajacek@tmr.qld.gov.au [Sheryl.P.Zajacek@tmr.qld.gov.au]
Sent: Wednesday, 19 February 2014 11:58 AM
To: SLAM - Ipswich
CC: doreen.sharpe@dnrm.qld.gov.au
Subject: Reference Number 2014/000409

**Application for Permanent Road Closure
The Unnamed Road off East Egypt Road, Egypt and Flagstone Creek Roads**

Thank you for your email of 17 February 2014

I advise that the Department of Transport and Main Roads offers no objection to the proposed permanent road closure as shown on you Drawing No DWG 14/025

Kind regards,

Sheryl Zajacek
Program Support Officer | Downs South West
Program Delivery And Operations | Department of Transport and Main Roads

Ground Floor | 7-9 Clopton Street | Toowoomba Qld 4350
Locked Bag 1 | Warwick Qld 4370
P: (07) 46390767 | F: (07) 46390750
E: sheryl.p.zajacek@tmr.qld.gov.au
W: www.tmr.qld.gov.au

WARNING: This email (including any attachments) may contain legally privileged, confidential or private information and may be protected by copyright. You may only use it if you are the person(s) it was intended to be sent to and if you use it in an authorised way. No one is allowed to use, review, alter, transmit, disclose, distribute, print or copy this email without appropriate authority.

If this email was not intended for you and was sent to you by mistake, please telephone or email me immediately, destroy any hardcopies of this email and delete it and any copies of it from your computer system. Any right which the sender may have under copyright law, and any legal privilege and confidentiality attached to this email is not waived or destroyed by that mistake.

It is your responsibility to ensure that this email does not contain and is not affected by computer viruses, defects or interference by third parties or replication problems (including incompatibility with your computer system).

Opinions contained in this email do not necessarily reflect the opinions of the Department of Transport and Main Roads, or endorsed organisations utilising the same infrastructure.

From: ! NI Road Closures & Easements [Network.Integrity.Road.Closures@team.telstra.com]
Sent: Wednesday, 19 February 2014 12:36 PM
To: Sharpe Doreen
CC: SLAM - Ipswich
Subject: RE: Application for Permanent Road Closure - The Unnamed Road offEast Egypt Road, Egypt & Flagstone Creek
Attachments: SKMBT_C451 14021709490.pdf; No Telstra Assets Identified 2014-000409.pdf

Good afternoon Doreen,

Please find attached Telstra's response in regards to : 2014/000409
Our ref: QF152049-1

If you have any questions, please feel free to contact us on: 1800 653 935

Have a lovely day,



Megan Smith

Team Leader - Telstra Plant Locations

Field Delivery | Service Delivery | Telstra Operations

Brisbane | QLD | 4001 | Australia

PH: 1800 653 935 | E: megan.smith@team.telstra.com

Dial Before You Dig : the essential first step in preventing damage to Telstra's underground assets. <http://1100.com.au>

This communication may contain confidential or copyright information of Telstra Corporation Limited (ABN 33 051 775 556). If you are not an intended recipient, you must not keep, forward, copy, use, save or rely on this communication, and any such action is unauthorised and prohibited. If you have received this communication in error, please reply to this email to notify the sender of its incorrect delivery, and then delete both it and your reply.

From: Sharpe Doreen [mailto:Doreen.Sharpe@dnrm.qld.gov.au]

Sent: Monday, 17 February 2014 10:12 AM

To: property@energex.com.au; property@urbanutilities.com.au; ! NI Road Closures & Easements; info@nationaltrail.com.au; propsearch@powerlink.com.au; RPF.CMU@tmr.qld.gov.au; metropolitanregion@tmr.qld.gov.au

Subject: FW: Application for Permanent Road Closure - The Unnamed Road offEast Egypt Road, Egypt & Flagstone Creek

Our Ref: 2014/000409

Hello

Please find enclosed a copy of the Notice published in the Government Gazette of 14 February 2014 and drawing DWG 14/025 relative to the above application.

The applicant advises that the proposed use of the subject area, if the road closure is approved would be fire break and buffer zone purposes as part of a property bush fire management plan

To enable full consideration to be given to this matter please submit your views and/or requirements, in writing, to this office by 27 March 2014. If no reply is received by that date it will be assumed you have no objection to the application.

Any objections received may be viewed by other parties interested in the proposed road closure in accordance with the provisions of the *Right to Information Act 2009*.

If you wish to discuss this matter please contact Doreen Sharpe on 07 3884 5346.

All future correspondence relative to this matter is to be referred to the contact an Officer at the address below or by email to slam-ipswich@derm.qld.gov.au. Any hard copy correspondence received will be electronically scanned and filed. For this reason, it is recommended that any attached plans, sketches or maps be no larger than A3-sized.

Please quote reference number 2014/000409 in any future correspondence.

Regards

Doreen Sharpe
Land Officer, Land Management, Ipswich
Department of Natural Resources and Mines
Telephone: 3884 5346 **Fax:** 3884 5396
Email: doreen.sharpe@dnrm.qld.gov.au

PO Box 864, Ipswich Q 4305
Level 1, 114 Brisbane Street, Ipswich

The information in this email together with any attachments is intended only for the person or entity to which it is addressed and may contain confidential and/or privileged material. There is no waiver of any confidentiality/privilege by your inadvertent receipt of this material.

Any form of review, disclosure, modification, distribution and/or publication of this email message is prohibited, unless as a necessary part of Departmental business.

If you have received this message in error, you are asked to inform the sender as quickly as possible and delete this message and any copies of this message from your computer and/or your computer system network.

DNRM RTI/DL Release



Telstra Plan Services

Level 18, 275 George Street
Brisbane, QLD 4000

Postal Address:
Locked Bag 3820
Brisbane, QLD 4000

Email: F0501488@team.telstra.com

Date **19/02/2014**

Your Ref: 2014/000409

Our Ref: **QF152049-1**

Doreen Sharpe

Doreen.Sharpe@dnrm.qld.gov.au

Dear Doreen,

Re: Application For Permanent Road Closure - Unnamed Road Off East Egypt Road - Flagstone Creek.

Thank you for your communication dated **17/02/14** in relation to the location specified above.

Telstra's plant records indicate that there are no Telstra assets within the area of the proposal. Subject to your compliance with the below conditions, **Telstra has NO OBJECTIONS** to the Application for Permanent Road Closure.

We note that our plant records merely indicate the approximate location of the Telstra assets and should not be relied upon as depicting a true and accurate reflection of the exact location of the assets. Accordingly, we note that all individuals have a legal "Duty of Care" that must be observed when working in the vicinity of Telstra's communication plant. It is the constructor's/land owner's responsibility to anticipate and request the nominal location of Telstra plant via **Dial Before You Dig "1100" number** in advance of any construction activities in the vicinity of Telstra's assets.

On receipt of plans, notwithstanding the recorded location of Telstra's plant, the constructor/land owner is responsible for obtaining a Telstra accredited Asset Plant Locator to perform cable location, potholing and physical exposure to confirm the actual location of the plant prior to the commencement of site civil work. Telstra reserves all rights to recover compensation for loss or damage caused by interference to its cable network or other property.

Telstra would also appreciate due confirmation when this proposed acquisition proceeds so as to update its Cadastre records. Information regarding acquisition of the land would be of benefit to us and should be directed to the following location:

Queensland

Telstra - Cadastre Updates
PO Box 102
Toormina NSW 2452
Attention: - Sally Cameron
F1103453@team.telstra.com
F1103452@team.telstra.com

Please pass all information contained in this communication to all parties involved in this proposed process. If you have any difficulties in meeting the above conditions or if you have any questions relating to them, please do not hesitate to contact us at F0501488@team.telstra.com.

Yours sincerely,

sch4p4(6) Personal information

Megan Smith
Telstra Telstra Plan Services

DNRM RTI DL Release

DRAWING

Sheet 1 of 1



159
CC1070

104
SPI44471

Locality of Flagstone Creek

**Road Proposed To Be
Permanently Closed**

abt 2.3 ha

2
RP108549

1
RP108549

96
CC142

Locality of Egypt

161
CC677

105
CC206

162
CP846036

162
CP846036

162
CP846036



Scale - 1:5000



Prepared by
IPSWICH OFFICE
RESOURCE ASSESSMENT
and INFORMATION
SOUTH REGION
DEPT OF NATURAL RESOURCES
and MINES
LEVEL 1
TOWER CENTRAL
IPSWICH Q 4305

ROAD PROPOSED TO BE PERMANENTLY CLOSED



PROPOSAL

Scale 1 : 5000
Plan at A3 Paper Size

PARISH : CAMPBELL
EGYPT &
LOCALITY : FLAGSTONE CREEK

COUNTY CHURCHILL
REGIONAL COUNCIL OF
LOCAL AUTH : LOCKYER VALLEY

DWG 14/025

Compiled from DCDB & Sketch on File

Drawn by JKN

File Ref Case Id 2014/000409

Map Ref 9342 - 43124

Date 29/01/2014

© The State of Queensland (Dept of Natural Resources & Mines) 2014
Base date extracted from the Digital Cadastral Database on the 29/01/2014

*Land Act 1994***OBJECTIONS TO PROPOSED ROAD CLOSURE NOTICE
(No 06) 2014****Short title**

1. This notice may be cited as the *Objections to Proposed Road Closure Notice (No 06) 2014*.

Application for road closure [s.100 of the Act]

2. Applications have been made for the permanent closure of the roads mentioned in the Schedule.

Objections

3.(1) An objection (in writing) to a proposed road closure mentioned in the Schedule may be lodged with the Regional Service Director, Department of Natural Resources and Mines, at the regional office for the region in which the road is situated.

(2) Latest day for lodgement of objections is **27 March 2014**.

(3) Any objections received may be viewed by other parties interested in the proposed road closure under the provisions of the *Right to Information Act 2009*. If you lodge an objection, please include in your objection letter whether you would like to be consulted if this issue becomes the subject of an access request under the *Right to Information Act 2009*.

Plans

4. Inspection of the plans of the proposed road closures may be made at-

- (a) the Department of Natural Resources and Mines Offices at Ipswich and Nambour; and
- (b) the Local Government Offices of Lockyer Valley Regional and Noosa Shire;

for a particular plan in that district or that local government area.

SCHEDULE**PERMANENT CLOSURE****South Region, Ipswich Office**

1 An area of about 2.3 ha being part of the unnamed road off East Egypt Road abutting Lots 1 and 2 on RP108549 (parish of Campbell, localities of Egypt and Flagstone Creek) and shown as road proposed to be permanently closed on Drawing 14/025. (2014/000409)

South Region, Nambour Office

*2 An area of about 1.14 ha being part of the unnamed road intersecting Lot 21 on NPW1150 (parish of Laguna, locality of Noosa North Shore) and shown as road proposed to be permanently closed on Drawing 13/073. (2012/004842)

*The proposed closure of this road is in conjunction with the proposed opening of another road.

ENDNOTES

1. Published in the Gazette on 14 February 2014.
2. Not required to be laid before the Legislative Assembly.
3. The administering agency is the Department of Natural Resources and Mines.

Gov. Gaz., 14 February 2014, No. 28 page 137

Brisbane

© The State of Queensland 2014

From: Sharpe Doreen [Doreen.Sharpe@dnrm.qld.gov.au]

Sent: Monday, 24 February 2014 9:25 AM

To: sch4p4(6) Personal information

Subject: Application for Permanent Road Closure - Unnamed Road off East Egypt Road, Egypt

Our Ref: 2014/000409

Hello sch4p4(6) Personal information

Reference is made to your email below lodging an objection to the above application.

The information will be considered as part of the Department's investigation of the application. You will be advised of the outcome when the investigations are complete.

With regards to your query concerning the name of the applicant. Due to privacy restrictions, I cannot advise you of the applicant's name. However, I can advise that the applicant is an adjoining owner to the subject road area.

To find out the applicant's name, you may be able to apply to do a right to information search. You should contact the department's Right to Information section on (07) 3330 6111 for more information or you can access the relevant information at the following link:

<http://www.dnrm.qld.gov.au/our-department/right-to-information>.

If you wish to discuss this matter please contact Doreen Sharpe on 07 3884 5346.

All future correspondence relative to this matter is to be referred to the contact Officer at the address below or by email to SLAM-ipswich@dnrm.qld.gov.au. Any hard copy correspondence received will be electronically scanned and filed. For this reason, it is recommended that any attached plans, sketches or maps be no larger than A3-sized.

Please quote reference number 2014/000409 in any future correspondence.

Regards

Doreen Sharpe
Land Officer, Land Management, Ipswich
Department of Natural Resources and Mines
Telephone: 3884 5346 **Fax:** 3884 5396
Email: doreen.sharpe@dnrm.qld.gov.au

PO Box 864, Ipswich Q 4305
Level 1, 114 Brisbane Street, Ipswich

From: sch4p4(6) Personal information
Sent: Friday, 21 February 2014 11:35 AM
To: SLAM - Ipswich
Subject: Re: road closer objection. (Doreen Sharpe)

On 21/02/2014, at 11:31 AM, sch4p4(6) Personal information > wrote:

From: Sharpe Doreen [Doreen.Sharpe@dnrm.qld.gov.au]
Sent: Monday, 24 March 2014 2:42 PM
To: sch4p4(6) Personal information
Subject: FW: objection to road closure Ref No: 2104/000409
Attachments: Road Closure objection reference 2014000409.pdf

Our Ref 2014/000409

sch4p4(6) Personal information

Reference is made to your email below lodging an objection to the above application.

The information will be considered as part of the Department's investigation of the application. You will be advised of the outcome when the investigations are complete.

If you wish to discuss this matter please contact Doreen Sharpe on 07 3884 5346.

All future correspondence relative to this matter is to be referred to the contact Officer at the address below or by email to SLAM-ipswich@dnrm.qld.gov.au. Any hard copy correspondence received will be electronically scanned and filed. For this reason, it is recommended that any attached plans, sketches or maps be no larger than A3-sized.

Please quote reference number 2014/000409 in any future correspondence.

Regards

Doreen Sharpe
Land Officer, Land Management, Ipswich
Department of Natural Resources and Mines
Telephone: 3884 5346 **Fax:** 3884 5396
Email: doreen.sharpe@dnrm.qld.gov.au

PO Box 864, Ipswich Q 4305
Level 1, 114 Brisbane Street, Ipswich

From: sch4p4(6) Personal information
Sent: Thursday, 20 March 2014 8:27 PM
To: SLAM - Ipswich
Subject: objection to road closure Ref No: 2104/000409

Dear Doreen,

Please find attached our letter of objection to the road closure off East Egypt Road,

Regards,

sch4p4(6) Personal information

From: SHARPE Doreen [Doreen.Sharpe@dnrm.qld.gov.au]
Sent: Monday, 5 May 2014 1:53 PM
To: mail@lvrc.qld.gov.au
CC: Julie Millard (JMillard@lvrc.qld.gov.au)
Subject: FW: Application for Permanent Road Closure - part of the Unnamed Road Off East Egypt Road, Flagstone Creek
Attachments: SKMBT_C451 14021709490.pdf

Our Ref: 2014/000409

Hello

With reference to my email below.

A response to my email was due to be received by 27 March 2014. However, as at this date no response has been received.

Could you please submit Council's views to the application as a matter of urgency and by 19 May 2014.

If you offer an objection to the application, a full explanation stating the reason for such an objection should be forwarded to this Office.

If you wish to provide a response but are unable to do so before the due date, please contact the author before the due date to arrange a more suitable timeframe. If a response is not received by the due date and no alternative arrangements have been made, it will be assumed you have no objections or requirements in relation to this matter.

Regards

Doreen Sharpe
Land Officer, Land Management, Ipswich
Department of Natural Resources and Mines
Telephone: (07) 3894 8114
Email: doreen.sharpe@dnrm.qld.gov.au

PO Box 864, Ipswich Q 4305
Level 4, 117 Brisbane Street, Ipswich

From: Sharpe Doreen
Sent: Monday, 17 February 2014 10:12 AM
To: mail@lvrc.qld.gov.au
Subject: Application for Permanent Road Closure - part of the Unnamed Road Off East Egypt Road, Flagstone Creek

Our Ref: 2014/000409

Hello

Please find enclosed a copy of the Notice published in the Government Gazette of 14 February 2014 and drawing DWG 14/025 relative to the above application.

You are requested to display the notice at your office for the purpose of being viewed by the public in terms of Section 100 of the *Land Act 1994*. Your views and/or requirements are also requested in respect of the application.

The applicant advises that the proposed use of the subject areas, if the road closure is approved would be for fire break and buffer zone purposes as part of a property bush fire management plan.

Could Council please advise the Department of its views or requirements to the application, that the department should consider when assessing this application:

Objections to the application, and any views or requirements that may affect the future use of the land should be received by close of business on 27 March 2014. If you offer an objection to the application, a full explanation stating the reason for such an object should be forwarded to this Office.

If you wish to provide a response but are unable to do so before the due date, please contact the author before the due date to arrange a more suitable timeframe. If a response is not received by the due date and no alternative arrangements have been made, it will be assumed you have no objections or requirements in relation to this matter.

This information has been provided to you in confidence for the purpose of seeking your views on this matter. It is not to be used for any other purpose, or distributed further to any person, company, or organisation, without the express written permission of the department unless required.

Any objections received may be viewed by other parties interested in the proposed road closure in accordance with the provisions of the *Right to Information Act 2009*.

If you wish to discuss this matter please contact Doreen Sharpe on 07 3884 5346.

All future correspondence relative to this matter is to be referred to the contact Officer at the address below or by email to slam-ipswich@dnrm.qld.gov.au. Any hard copy correspondence received will be electronically scanned and filed. For this reason, it is recommended that any attached plans, sketches or maps be no larger than A3-sized.

Please quote reference number 2014/000409 in any future correspondence.

Regards

Doreen Sharpe

Land Officer, Land Management, Ipswich
Department of Natural Resources and Mines

Telephone: 3884 5346 **Fax:** 3884 5396

Email: doreen.sharpe@dnrm.qld.gov.au

PO Box 864, Ipswich Q 4305

Level 1, 114 Brisbane Street, Ipswich



159
CC1070

104
SPI44471

Locality of Flagstone Creek

**Road Proposed To Be
Permanently Closed**

abt 2.3 ha

2
RP108549

1
RP108549

96
CC142

Locality of Egypt

161
CC677

105
CC206

162
CP846036

162
CP846036

162
CP846036



Scale - 1 : 5000



Prepared by
IPSWICH OFFICE
RESOURCE ASSESSMENT
and INFORMATION
SOUTH REGION
DEPT OF NATURAL RESOURCES
and MINES
LEVEL 1
TOWER CENTRAL
IPSWICH Q 4305

ROAD PROPOSED TO BE PERMANENTLY CLOSED



PROPOSAL

Scale 1 : 5000
Plan at A3 Paper Size

PARISH : CAMPBELL
EGYPT &
LOCALITY : FLAGSTONE CREEK

COUNTY : CHURCHILL
REGIONAL COUNCIL OF
LOCAL AUTH : LOCKYER VALLEY

DWG 14/025

Compiled from DCDB & Sketch on File

Drawn by JKN

File Ref Case Id 2014/000409

Map Ref 9342 - 43124

Date 29/01/2014

*Land Act 1994***OBJECTIONS TO PROPOSED ROAD CLOSURE NOTICE
(No 06) 2014****Short title**

1. This notice may be cited as the *Objections to Proposed Road Closure Notice (No 06) 2014*.

Application for road closure [s.100 of the Act]

2. Applications have been made for the permanent closure of the roads mentioned in the Schedule.

Objections

3.(1) An objection (in writing) to a proposed road closure mentioned in the Schedule may be lodged with the Regional Service Director, Department of Natural Resources and Mines, at the regional office for the region in which the road is situated.

(2) Latest day for lodgement of objections is **27 March 2014**.

(3) Any objections received may be viewed by other parties interested in the proposed road closure under the provisions of the *Right to Information Act 2009*. If you lodge an objection, please include in your objection letter whether you would like to be consulted if this issue becomes the subject of an access request under the *Right to Information Act 2009*.

Plans

4. Inspection of the plans of the proposed road closures may be made at-

- (a) the Department of Natural Resources and Mines Offices at Ipswich and Nambour; and
- (b) the Local Government Offices of Lockyer Valley Regional and Noosa Shire;

for a particular plan in that district or that local government area.

SCHEDULE**PERMANENT CLOSURE****South Region, Ipswich Office**

1 An area of about 2.3 ha being part of the unnamed road off East Egypt Road abutting Lots 1 and 2 on RP108549 (parish of Campbell, localities of Egypt and Flagstone Creek) and shown as road proposed to be permanently closed on Drawing 14/025. (2014/000409)

South Region, Nambour Office

*2 An area of about 1.14 ha being part of the unnamed road intersecting Lot 21 on NPW1150 (parish of Laguna, locality of Noosa North Shore) and shown as road proposed to be permanently closed on Drawing 13/073. (2012/004842)

*The proposed closure of this road is in conjunction with the proposed opening of another road.

ENDNOTES

1. Published in the Gazette on 14 February 2014.
2. Not required to be laid before the Legislative Assembly.
3. The administering agency is the Department of Natural Resources and Mines.

Gov. Gaz., 14 February 2014, No. 28 page 137

Brisbane

© The State of Queensland 2014

From: SHARPE Doreen [Doreen.Sharpe@dnrm.qld.gov.au]

Sent: Wednesday, 7 May 2014 9:11 AM

To: 'Caitlan Natalier'

Subject: RE: Your Ref: 2014/000409 - Application for Permanent Road Closure - part of the Unnamed Road off East Egypt Road, Flagstone Creek

Sorry Caitlan, I think someone else has already told me to send it straight to you both.

I just forgot this time.

But an extension as requested for the submission of Council views is OK.

Regards

Doreen Sharpe
Land Officer, Land Management, Ipswich
Department of Natural Resources and Mines
Telephone: (07) 3894 8114
Email: doreen.sharpe@dnrm.qld.gov.au

PO Box 864, Ipswich Q 4305
Level 4, 117 Brisbane Street, Ipswich

From: Caitlan Natalier [mailto:CNatalier@lvrc.qld.gov.au]

Sent: Monday, 5 May 2014 4:29 PM

To: SHARPE Doreen

Cc: Julie Millard

Subject: Your Ref: 2014/000409 - Application for Permanent Road Closure - part of the Unnamed Road off East Egypt Road, Flagstone Creek

Hi Doreen,

I have just now been sent a copy of your email of today chasing an urgent response to the above road application.

Unfortunately the original email was not sent to us when it arrived in February (I've just done a search and found it) and I can't see that it has been attended to.

Our next Council meeting is not until 28 May, so we will not be able to meet your extended deadline of 19 May. I realise you've been waiting for a response since February, however so that this matter can go through our internal processes, is it possible for us to respond by 6 June (when our Council minutes for the May meeting will be finalised)?

In future, could you please arrange for these requests to be sent directly to either myself or Julie Millard (or preferably both of us) so that we can make sure they don't get missed?

Thanks

Caitlan Natalier
Solicitor

P 07 54620 633
E cnatalier@lvrc.qld.gov.au

Lockyer Valley Regional Council
26 Railway Street (PO Box 82) Gatton Qld 4343
1300 00 5872 (LVRC)
www.lockyervalley.qld.gov.au

Please update all correspondence and references to:
LVRC
PO Box 82
GATTON QLD 4343

This email (including any attached files) is confidential and is for the intended recipient(s) only. If you received this email by mistake, please, as a courtesy, tell the sender, then delete this email.

The views and opinions are the originator's and do not necessarily reflect those of the Lockyer Valley Regional Council. Although all reasonable precautions were taken to ensure that this email contained no viruses at the time it was sent we accept no liability for any losses arising from its receipt.

DNRM RTI DL Release



159
CC1070

Part B
Road Proposed To Be
Permanently Closed
abt 3310 m²

104
SP144471

Part A
Road Proposed To Be
Permanently Closed
abt 1.99 ha

Locality of Flagstone Creek

160
CC809

2
RP108549

1
RP108549

96
CC142

160
CC809

161
CC677

162
CP846036

161
CC677

105
CC206

162
CP846036

Locality of Egypt

162
CP846036



DNRM RTI DL Release



Prepared by
IPSWICH OFFICE
RESOURCE ASSESSMENT
and INFORMATION
SOUTH REGION
DEPARTMENT OF NATURAL
RESOURCES and MINES
LEVEL 1
TOWER CENTRAL
IPSWICH Q 4305

ROAD PROPOSED TO BE PERMANENTLY CLOSED

PROPOSAL

Scale 1:6000 at A3 paper size

PARISH: CAMPBELL COUNTY: CHURCHILL
LOCALITY: EGYPT & FLAGSTONE CREEK LOCAL AUTH: REGIONAL COUNCIL OF LOCKYER VALLEY

DWG 14/040
27 of 29

From: SHARPE Doreen [Doreen.Sharpe@dnrm.qld.gov.au]
Sent: Thursday, 30 October 2014 11:34 AM
To: sch4p4(6) Personal information
Subject: Application for Permanent Road Closure
Attachments: dwg14-040.pdf

Our Ref: 2014/000409

sch4p4(6) Personal information

With reference to previous correspondence regarding the application for permanent road closure of part of East Egypt Road, Egypt.

I wish to advise that the application for permanent road closure as shown on the attached drawing has been refused.

The application has now been closed.

Regards

Doreen Sharpe
Land Officer, Land Management, Ipswich
Department of Natural Resources and Mines
Telephone: (07) 3894 8114
Email: doreen.sharpe@dnrm.qld.gov.au

PO Box 864, Ipswich Q 4305
Level 4, 117 Brisbane Street, Ipswich



159
CC1070

Part B
Road Proposed To Be
Permanently Closed
abt 3310 m²

104
SP144471

Part A
Road Proposed To Be
Permanently Closed
abt 1.99 ha

Locality of Flagstone Creek

160
CC809

1
RP108549

2
RP108549

96
CC142

160
CC809

161
CC677

162
CP846036

161
CC677

105
CC206

162
CP846036

Locality of Egypt

162
CP846036

0 100 200 300 400 500 600 metres

Scale 1:6000

0 50 mm 100 mm 150 mm



Prepared by
IPSWICH OFFICE
RESOURCE ASSESSMENT
and INFORMATION
SOUTH REGION
DEPARTMENT OF NATURAL
RESOURCES and MINES
LEVEL 1
TOWER CENTRAL
IPSWICH Q 4305

ROAD PROPOSED TO BE PERMANENTLY CLOSED



PROPOSAL

Scale 1:6000 at A3 paper size

PARISH: CAMPBELL

COUNTY: CHURCHILL

LOCALITY: EGYPT & FLAGSTONE CREEK

LOCAL AUTH: REGIONAL COUNCIL OF LOCKYER VALLEY

DWG 14/040
29 of 29