

STANDARD MAP NUMBER
9045-33244



SmartMap

An External Product of
SmartMap Information Services

Based upon an extraction from the
Digital Cadastral Data Base

MAP WINDOW POSITION &
NEAREST LOCATION



SUBJECT PARCEL DESCRIPTION

DCDB	No Lot/Plan Selected.
Lot/Plan	No Lot/Plan Selected.
Area/Volume	No Lot/Plan Selected.
Tenure	No Lot/Plan Selected.
Local Government	No Lot/Plan Selected.
Locality	No Lot/Plan Selected.
Parish	No Lot/Plan Selected.
County	No Lot/Plan Selected.
Segment/Parcel	No Lot/Plan Selected.

TL 220665
Additional area

CLIENT SERVICE STANDARDS

PRINTED (dd/mm/yyyy) 27/08/2014

DCDB 26/08/2014 (Lots with an area less than 5,000ha are not shown)

Users of the information recorded in this document (the Information) accept all responsibility and risk associated with the use of the Information and should seek independent professional advice in relation to dealings with property.

Despite Department of Natural Resources and Mines(DNRM)'s best efforts, DNRM makes no representations or warranties in relation to the Information, and, to the extent permitted by law, exclude or limit all warranties relating to correctness, accuracy, reliability, completeness or currency and all liability for any direct, indirect and consequential costs, losses, damages and expenses incurred in any way (including but not limited to that arising from negligence) in connection with any use of or reliance on the Information.

For further information on SmartMap products visit <http://nrw.qld.gov.au/property/mapping/blnmap>



Release

(c) The State of Queensland,
(Department of Natural
Resources and Mines) 2014.

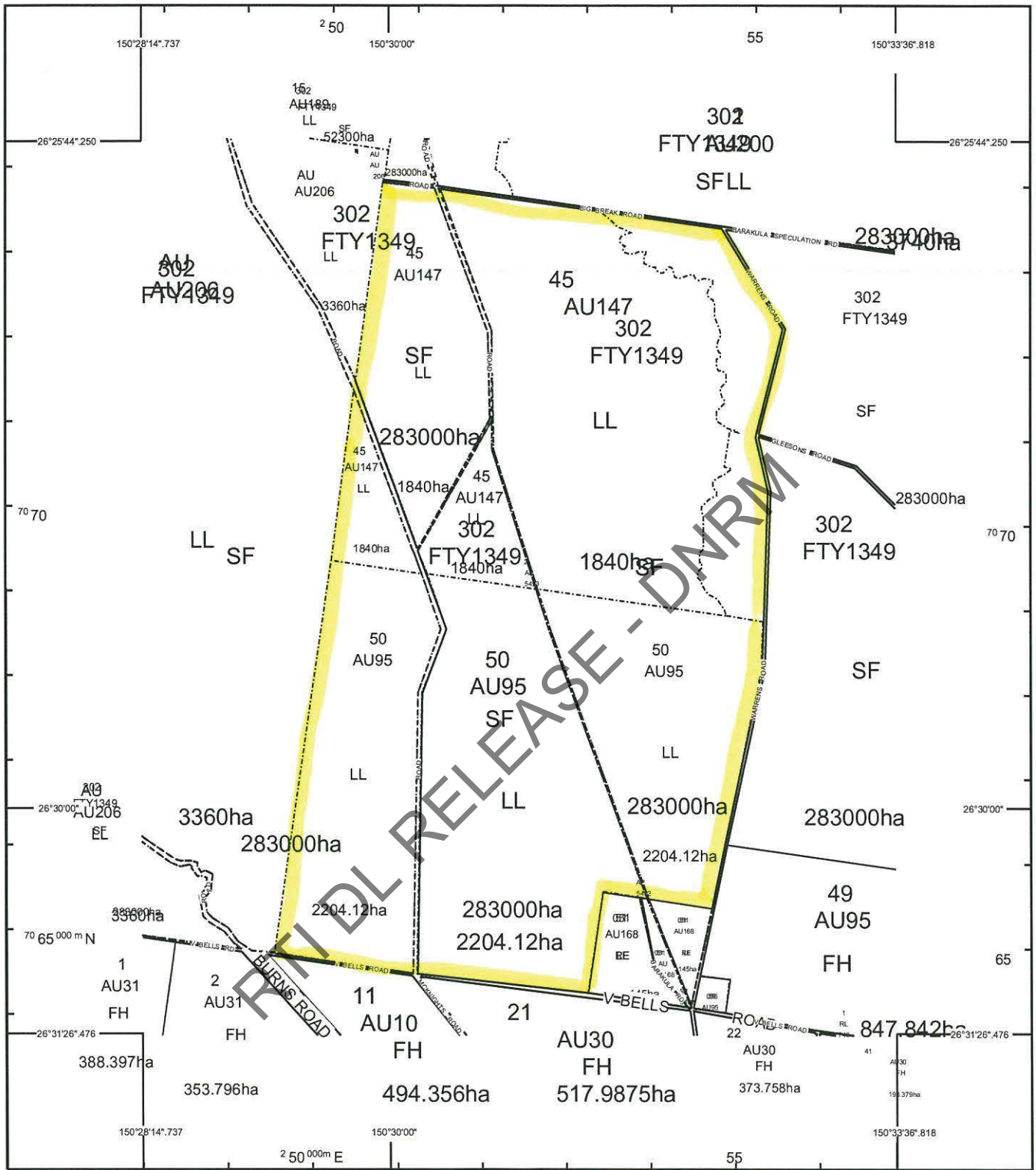

STANDARD MAP NUMBER
9045-33334



MAP WINDOW POSITION & NEAREST LOCATION

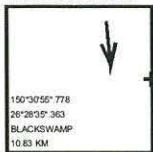

SUBJECT PARCEL DESCRIPTION

DCDB	
Lot/Plan	No Lot/Plan Selected.
Area/Volume	No Lot/Plan Selected.
Tenure	No Lot/Plan Selected.
Local Government	No Lot/Plan Selected.
Locality	No Lot/Plan Selected.
Parish	No Lot/Plan Selected.
County	No Lot/Plan Selected.
Segment/Parcel	No Lot/Plan Selected.

CLIENT SERVICE STANDARDS

PRINTED (dd/mm/yyyy) 09/05/2008

DCDB 08/05/2008 (Lots with an area less than 4.000ha are not shown)

Users of the information recorded in this document (the Information) accept all responsibility and risk associated with the use of the Information and should seek independent professional advice in relation to dealings with property.

Despite Department of Natural Resources and Water (NRW)'s best efforts, NRW makes no representations or warranties in relation to the Information, and, to the extent permitted by law, exclude or limit all warranties relating to correctness, accuracy, reliability, completeness or currency and all liability for any direct, indirect and consequential costs, losses, damages and expenses incurred in any way (including but not limited to that arising from negligence) in connection with any use of or reliance on the Information

For further information on SmartMap products visit <http://nrw.qld.gov.au/property/mapping/blinmap>

SmartMap

An External Product of
SmartMap Information Services
Based upon an extraction from the
Digital Cadastral Data Base



Release

**Queensland
Government**

**Natural Resources
and Water**

(c) The State of Queensland,
Natural Resources and Water, 2008.



eLVAS Client Interaction Report

For Interaction id: 1140712

Contact Details

Business unit: State Land Asset Management
Business context: Written (Inwards) Case
Interaction method: Email
Interaction date: 23-May-2014 4:49 PM
Entered by: Geitz, Rhonda
Reference: Stuart Henry

Contact with: Department of National Parks, Re, QPWS renewals and road actions

Documents

Document Type	Title	Received/Sent
Incoming email	QPWS Objection	23-May-2014

Interaction Record History

Service Centre: Warwick
Associated to Case: 2013/007135
Revision No.: 0
Updated by: Geitz, Rhonda
Date: 23-May-2014
Details:

Assignment History

RTI/DL RELEASE - DNR/M

LANG Jennifer (Admin Review)

From: GEITZ Rhonda
Sent: Wednesday, 30 April 2014 8:20 AM
To: QPWS Estate
Subject: FW: Application for a term lease over part of Lot 302 on FTY1349, Barakula State Forest (my ref: 2013/007135)
Attachments: SmartMap for 45 AU147 & 50 AU95 @ 09-05-2008.pdf; Current SmartMap for 10 AU83 & 302 FTY1349.pdf; EPA views - objection @ 30-10-2008.pdf

Dear Sir/Madam

Would you please be able to advise when we can expect to receive your views to the below mentioned application for a lease over an area of State Forest, full details contained in the email trail.

Thanks

Rhonda

Rhonda Geitz

Senior Land Officer, Land Services

Department of Natural Resources and Mines

Telephone: 07 4661 0210, Facsimile: 07 4661 5215

Mobile: [redacted] Provides the protection of an individuals right to privacy

Email: rhonda.geitz@dnrm.qld.gov.au

Cnr Guy & Fitzroy Streets

PO Box 2, Warwick QLD 4370

From: Looker Susann

Sent: Tuesday, 25 March 2014 3:53 PM

To: QPWS Estate

Subject: Application for a term lease over part of Lot 302 on FTY1349, Barakula State Forest (my ref: 2013/007135)

Hi folks,

Just checking that this application for a new lease (i.e. not a renewal) over a State forest hasn't fallen through the cracks.

Thank you.

Susann Looker

Land Administration Officer

Land Services

Department of Natural Resource and Mines

Telephone: 07 4661 0213

Facsimile: 07 4661 5215

Email: susann.looker@dnrm.qld.gov.au

www.dnrm.qld.gov.au

Cnr Guy & Fitzroy Streets, Warwick

PO Box 2, Warwick Qld 4370

All applications to change tenure or for use of State land administered under the Land Act are to be forwarded to the central point of lodgement. The central point of lodgement email address is SLAMlodgement@dnrm.qld.gov.au. For more information please refer to [Application forms](#) on the departments webpage.

From: Looker Susann
Sent: Friday, 17 January 2014 1:50 PM
To: QPWS Estate
Subject: Application for a term lease over part of Lot 302 on FTY1349, Barakula State Forest (my ref: 2013/007135)

Author Susann Looker
File / Ref number 2013/007135
Directorate / Unit State Land Asset Management
Phone 07 46610200

17 January 2014

Department of National Parks, Recreation, Sport and Racing
PO Box 3130
Red Hill Qld 4701

Dear Sir/Madam

Application for a term lease over part of Lot 302 on FTY1349, Barakula State Forest

On 30 October 2008, QPWS advised they objected the renewal of Term Lease 213501 over Lot 45 on AU147 and Lot 50 on AU95 and that any future grazing, if authorized, would be administered by QPWS under provisions of the *Forestry Act 1959*.

The lessee was advised on 9 October 2009 to contact QPWS to discuss the issue of a Grazing Authority under the *Forestry Act 1959*. The lease expired on 30 January 2010.

The same lessee has lodged an application for a lease over the same area of the expired lease. The enclosed Smartmap dated 9 May 2008 and current Smartmap shows the subject land and the surrounding locality.

Please advise if your agency has any issues that the department should consider when assessing this application in terms of Section 159 (1) of the *Land Act 1994*. Particular attention in your reply should be given to the following:-

- (a) Whether any part of the lease needs to be set aside and declared as State Forest under the *Forestry Act 1959*;
- (b) Whether the public interest could be adversely affected other than about an issue, mentioned in paragraph (a), if the lease was granted;
- (c) Whether any part of the lease is needed for environmental or nature conservation purposes;
- (d) Whether a different form of tenure may be considered a more appropriate tenure.

Objections to the application, and any views or requirements that may affect the future use of the land should be received by close of business on **17 March 2014**. If you offer an objection to the proposal, a full explanation stating the reason for such an objection should be forwarded to this Office.

If you wish to provide a response but are unable to do so before the due date, please contact the author before the due date to arrange a more suitable timeframe. If a response is not received by the due date and no alternative arrangements have been made, it will be assumed you have no objections or requirements in relation to this matter.

This information has been provided in confidence for the purpose of seeking your views on this matter. It is not to be used for any other purpose, or distributed further to any person, company, or organisation, without the express written permission of the department unless required.

If you wish to discuss this matter please contact Susann Looker on 4661 0213.

All future correspondence relative to this matter is to be referred to the contact Officer at the address below or by email to slam-warwick@dnrm.qld.gov.au. Any hard copy correspondence received will be electronically scanned and filed. For this reason, it is recommended that any attached plans, sketches or maps be no larger than A3-sized.

Please quote reference number 2013/007135 in any future correspondence.

Yours sincerely

Susann Looker
for Senior Land Officer
Land Services
Department of Natural Resource and Mines
Telephone: 07 4661 0213
Facsimile: 07 4661 5215
Email: susann.looker@dnrm.qld.gov.au
www.dnrm.qld.gov.au
Cnr Guy & Fitzroy Streets, Warwick
PO Box 2, Warwick Qld 4370

Attached:
Historical views from QPWS
Smartmap dated 9 May 2008
Current Smartmap

RTI DL RELEASE - DNRM

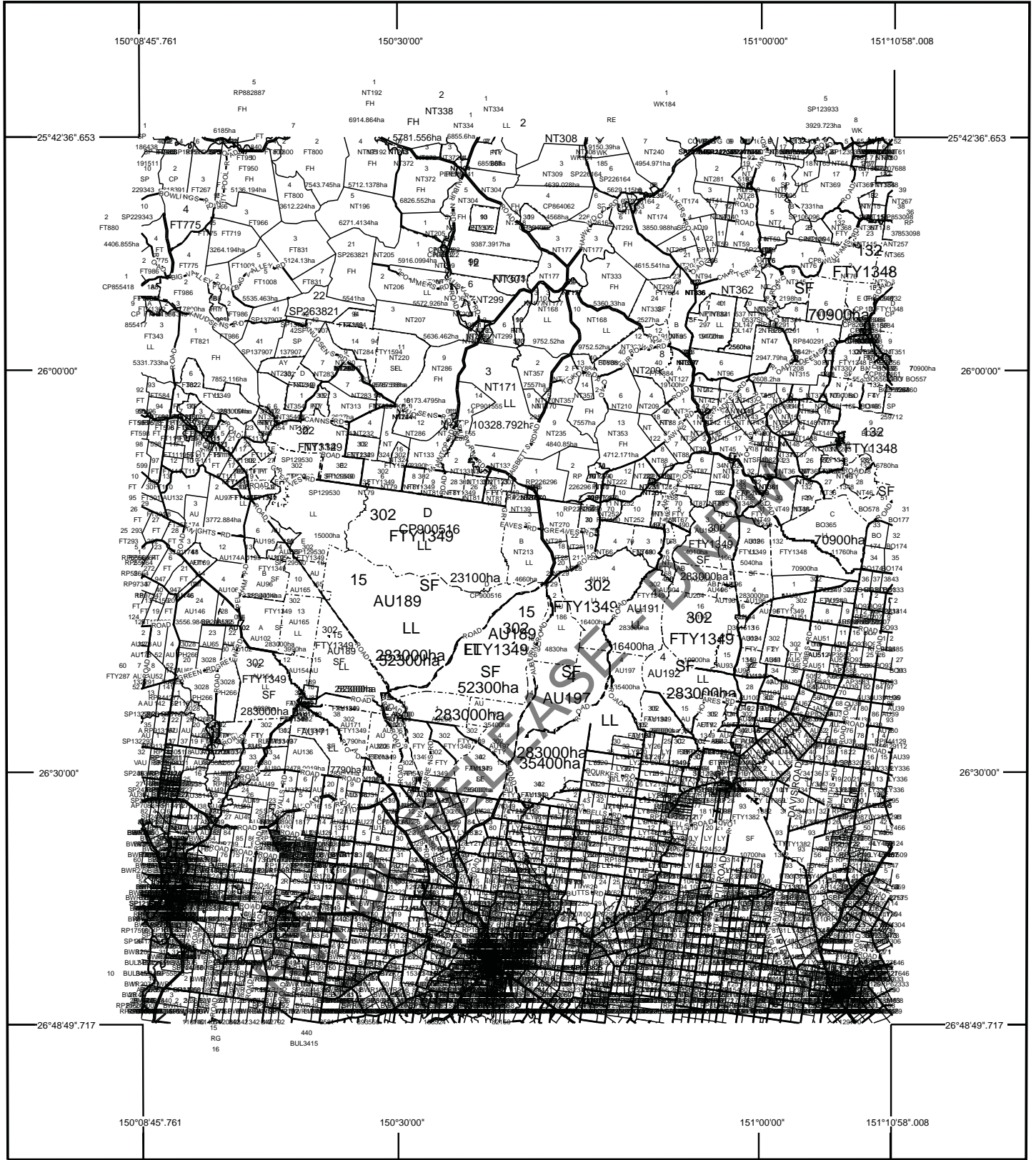

STANDARD MAP NUMBER
9045-31414



SmartMap

An External Product of
SmartMap Information Services
Based upon an extraction from the
Digital Cadastral Data Base

MAP WINDOW POSITION &
NEAREST LOCATION

SUBJECT PARCEL DESCRIPTION

DCDB	
Lot/Plan	No Lot/Plan Selected.
Area/Volume	No Lot/Plan Selected.
Tenure	No Lot/Plan Selected.
Local Government	No Lot/Plan Selected.
Locality	No Lot/Plan Selected.
Parish	No Lot/Plan Selected.
County	No Lot/Plan Selected.
Segment/Parcel	No Lot/Plan Selected.

CLIENT SERVICE STANDARDS

PRINTED (dd/mm/yyyy) 17/01/2014

DCDB 16/01/2014 (Lots with an area less than 10.000ha are not shown)

Users of the information recorded in this document (the Information) accept all responsibility and risk associated with the use of the Information and should seek independent professional advice in relation to dealings with property.

Despite Department of Natural Resources and Mines(DNRM)'s best efforts, DNRM makes no representations or warranties in relation to the Information, and, to the extent permitted by law, exclude or limit all warranties relating to correctness, accuracy, reliability, completeness or currency and all liability for any direct, indirect and consequential costs, losses, damages and expenses incurred in any way (including but not limited to that arising from negligence) in connection with any use of the Information.

File A

For further information on SmartMap products visit <http://nrw.qld.gov.au/property/mapping/blinmap>



Queensland
Government

(c) The State of Queensland,
(Department of Natural
Resources and Mines) 2014.



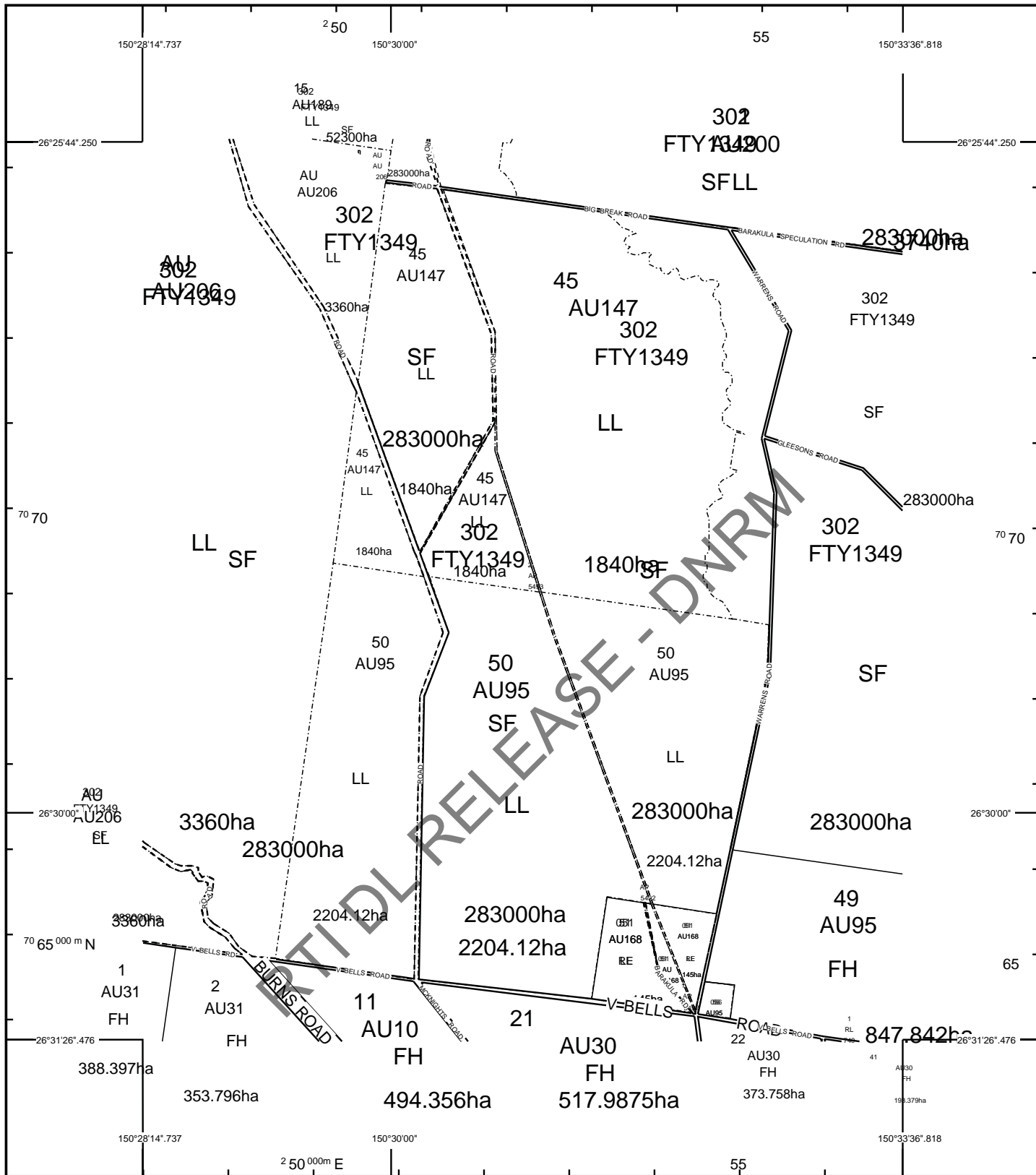

STANDARD MAP NUMBER
9045-33334



MAP WINDOW POSITION & NEAREST LOCATION

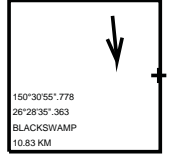

SUBJECT PARCEL DESCRIPTION

DCDB	No Lot/Plan Selected.
Lot/Plan	No Lot/Plan Selected.
Area/Volume	No Lot/Plan Selected.
Tenure	No Lot/Plan Selected.
Local Government	No Lot/Plan Selected.
Locality	No Lot/Plan Selected.
Parish	No Lot/Plan Selected.
County	No Lot/Plan Selected.
Segment/Parcel	No Lot/Plan Selected.

CLIENT SERVICE STANDARDS

PRINTED (dd/mm/yyyy) 09/05/2008

DCDB 08/05/2008 (Lots with an area less than 4.000ha are not shown)

Users of the information recorded in this document (the Information) accept all responsibility and risk associated with the use of the Information and should seek independent professional advice in relation to dealings with property.

Despite Department of Natural Resources and Water(NRW)'s best efforts, NRW makes no representations or warranties in relation to the Information, and, to the extent permitted by law, exclude or limit all warranties relating to correctness, accuracy, reliability, completeness or currency and all liability for any direct, indirect and consequential costs, losses, damages and expenses incurred in any way (including but not limited to that arising from negligence) in connection with any use or reliance on the Information

File A

For further information on SmartMap products visit <http://nrw.qld.gov.au/property/mapping/blinmap>

SmartMap

An External Product of SmartMap Information Services
Based upon an extraction from the Digital Cadastral Data Base



Queensland Government
Natural Resources and Water
41 of 42
(c) The State of Queensland, Natural Resources and Water, 2008.



14-217