

THE NORMANTON LAND AGENT'S DISTRICT.
To be open at the LAND OFFICE, NORMANTON, on
and after MONDAY, 10th FEBRUARY, 1958.
(On the Croydon Gold and Mineral Field.)
County of Surrey, parish of Croydon.

Area, 11 square miles.

Annual rent, 8s. per square mile.

Crown land comprising surrendered O.L. 748 situated
about four miles north from Croydon Railway Station and
described as follows:—

Commencing at the south-west corner of Tabletop Hold-
ing, and bounded thence by that holding east about two
miles twenty chains, and by lines south about five miles
sixty chains, north-westerly about two miles fifty-six chains,
and by O.L. 758 north about four miles thirty-two chains,
to the point of commencement;—exclusive of all reserved
land and land held under mining tenure within these
described boundaries.

O.L. 748 Norm.

Gov. Gaz., 23rd November, 1957, page 1216.

DO NOT SCALE

TENURE DETAILS

TENURE	DESCRIPTION
Occupation License	LOT 719 on OL434
Occupation License	LOT 785 on OL300
Mining Lease	ML3903 on MP35505
Mining Lease	ML 3879 on MP35504

NOTES

1. Description
 This plan was prepared for the client to show the properties situated in the catchment area of the Belmont Creek Dam. The boundaries shown are approximate only and the extent of the catchment area is only subject to field survey and any boundaries shown hereafter are subject to any other Authority which may have requirements under any relevant legislation. In particular, no reliance should be placed on the information on this plan for any financial dealings involving the land. This note is an integral part of this plan.

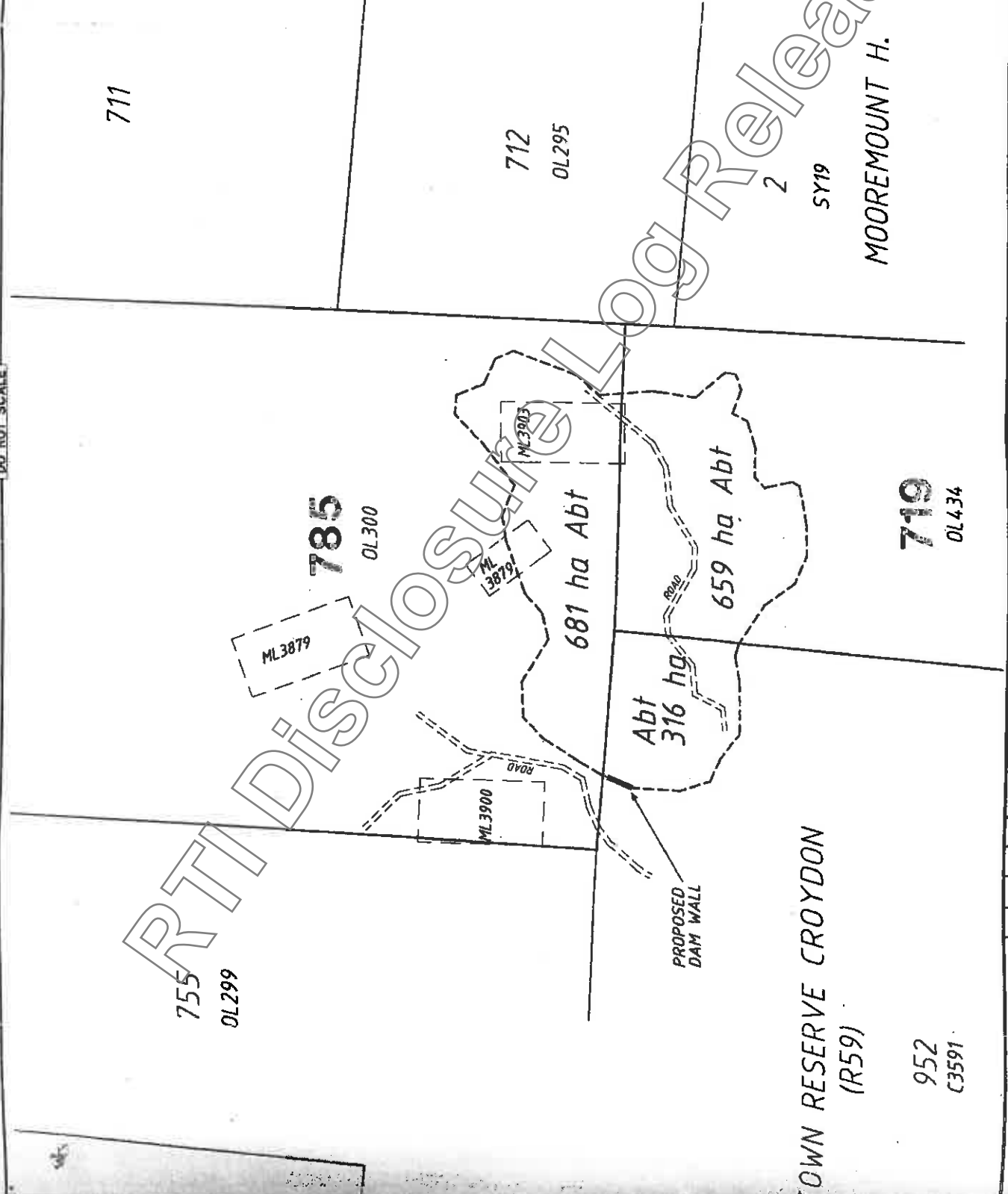

TOWN RESERVE CROYDON
(R59)

952
C3591

MOOREMOUNT H.

SY19

GHD Surveys Pty Ltd CONSULTING SURVEYORS - PROFESSIONAL 401 GOSWELL ST MELBOURNE VIC 3001 Tel: (03) 9487 7200 Fax: (03) 9487 7201 Email: info@ghdsurveys.com.au Website: www.ghdsurveys.com.au		15/0000 1-12-21
CROYDON SHIRE COUNCIL BELMORE CREEK DAM CATCHMENT AREA PLAN		18368-20

1663/70

"THE LAND ACTS, 1962 TO 1967"

VOL. 1663 FOL. 16

MAR-20-68 169418 D/S \$. 25 A DUPLST 5\$01

Occupation License

ANNEX

License No.: 785
District of NORMANTON
Date: 7th December, 1967

IN accordance with and subject to "The Land Acts, 1962 to 1967",

ALAN ROY FLETCHER

Minister for Lands,

hereby authorise GEORGE HAROLD REESE and ANDREW EDWARD DOWLING, as joint tenants

of CROYDON 4870

to occupy until 31st December next, and thereafter from year to year, so long as the rent fixed from time to time in terms of "The Land Acts, 1962 to 1967" is paid, as prescribed, or until this License is determined in the manner hereinafter mentioned, the lands in the abovementioned District more particularly described in the Schedule hereto. The License shall be determinable at any time with respect to the whole or any specified part of the said land by three months' notice given by the Minister to the Licensee. Provided always that the whole or any part of the said land may at any time be opened for selection leased or sold or be reserved under the said Acts, and if the whole or any part of the said land is so selected, leased, sold or reserved, the License shall be thereby determined with respect to the land or as the case may be such part and in case of part only of the land, subject to the said Acts as to reduction of rent.

Special Condition: NIL

GIVEN under my hand the Fifth day of January 19 68.

[Signature]
Secretary, Land Administration Commission,
the delegate of the Minister for Lands.

[SEE BACK]

STAMP DUTIES OFFICE
092545 * 20.MAR.1968
BRISBANE

SCHEDULE

District:

NORMANTON

Date of Notification:

6th October, 1967

Page of "Gazette":

450

County:

SURREY

Lot 785 on Plan DL300

Parish:

CROYDON and BARRABA.

Portion or Name of Block:

Crown land situated about two miles north of Croydon

Area: 32 square miles

Annual Rent: \$48.00

DESCRIPTION (Within the Croydon Gold and Mineral Field)

Commencing at the south-east corner of Tabletop Holding, and bounded thence by that holding, a line and that holding northerly to Strathmore Holding, by that holding easterly to the north-west corner of O.L. 711, by that O.L. south-easterly and southerly to O.L. 712, by that O.L. southerly to the north-eastern corner of O.L. 719, by that O.L. and R. 59 Town Reserve westerly to the south-east corner of O.L. 755, by that O.L. northerly to the southern boundary of Tabletop Holding, and by that holding easterly to the point of commencement; - exclusive of roads and any mining tenures.

Consequent upon the introduction of a new system of mapping of

the within-described Holding the area thereof is amended to 88. sq. kms. and the annual rent remain unaltered as from 1st January, 1975.

TRANSFER of the Lessee's Interest in the within-described holding to ANDREW EDWARD DOWLING and THOMAS HENRY DOWLING as joint tenants

Registered: 10 JUN 1977 Registrar of Dealings

TRANSFER of the Lessee's Interest in the within-described holding to JOHN EDWARD PICKERING as trustee for the Table Top Trust and THOMAS HENRY DOWLING as tenants in common in equal interests. Registered: 3 FEB 1981 Registrar of Dealings

IN terms of Regulation 41A (1) of the Land Regulations, the description of the Land comprised in the within lease is amended to lot 785 on plan DL300

Registrar of Dealings. Stamp

3/71

Occupation License.



No.: 711

District of **Normanton**

Date: **1st June, 1945**



IN accordance with and subject to "*The Land Acts, 1910 to 1984*," and ~~"The Prickly-pear Land Acts, 1922 to 192~~," I **ARTHUR JONES**

Secretary for Public Lands, hereby authorise **Andrew Edward Dowling, Junior** of **Oroydon, North Queensland,**

to occupy until 31st December next, and thereafter from year to year, so long as the rent fixed from time to time in terms of "*The Land Acts, 1910 to 1984*," is punctually paid, or until this License is determined in the manner hereinafter mentioned, the lands in the abovementioned District more particularly described in the Schedule hereto. The License shall be determinable at any time with respect to the whole or any specified part of the said land by three months' notice given by the Minister to the Licensee subject to the provisions of "*The Land Acts, 1910 to 1984*," as to abatement of rent. Provided always that the whole or any part of the said land may at any time be notified to be open for selection under "*The Land Acts, 1910 to 1984*," and ~~"The Prickly-pear Land Acts, 1922 to 192~~," or be reserved under the said Acts, or be leased under the said Acts, and if the whole or any part of the said land is so selected, leased, or reserved, the License shall as to the whole or such part thereof, as the case may be, and subject to the said provisions as to abatement of rent, be thereby forthwith determined.

Special Condition: **Nil.**

GIVEN under my hand the

Twentieth day of *July* 19*45*

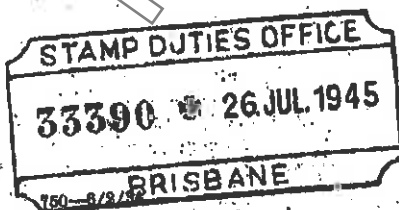

A Jones
Secretary for Public Lands.

[SEE BACK.]

PROVISIONAL LICENSE ISSUED

SCHEDULE.

Normanton

Location: 4th July, 1941

Gazette: 22 and 25

County: Surrey

Parish: Golden Valley

Portion or Name of Block: Lot 711 on Plan 06294

Area: 5 1/2 square miles

DESCRIPTION.

Commencing at the south-west corner of Inorumie Holding (being a point about two miles sixty-eight and a half chains west from an apple-tree marked broad-arrow over N 1), and bounded thence by that holding north to Wallabadah Holding, by that holding west about ten miles, by lines south-easterly about two miles, south about five miles sixty-four chains and east about three miles by O.L. 524 north about six miles ten chains, east about three miles and south about six miles ten chains, and by lines east about three miles twenty-four chains and north to the point of commencement; - exclusive of reserved lands and any mining tenements.

Consequent upon the introduction of new system mapping, the area of the within-described license has been amended to 446 km² as from the 1st January, 1975. The annual rent remains unaltered.

Registrar of Dealings

TRANSFER of the licensee's interest in the within-described license to JOHN EDWARD PICKERING as trustee for the Table Top Trust

Registered: 13 FEB 1981

Registrar of Dealings

IN terms of Regulation 41A (1) of the Land Regulations, the description of the Land comprised in the within lease is amended to lot 711 on plan 06294

Stamp
Registrar of Dealings

Queensland Trustees Limited as personal representative of John Edward Pickering deceased the trustee of The Table Top Trust

is now the registered licensee of the within-described license.

TRANSMISSION BY DEATH No. K783877J

PRODUCED 24 Sep 1991

REGISTERED

25 NOV 1991

REGISTRAR OF DEALINGS

Occupation License.

No.: 712

Lot of **Horamton**

Date: **1st June, 1945**

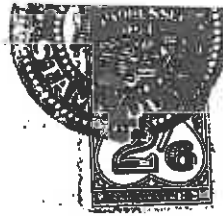

In accordance with and subject to "*The Land Acts, 1910 to 1935*," and ~~and the~~ *Prickly-pear Land Acts, 1932 to 1935*," I **ARTHUR JONES**

Secretary for Public Lands, hereby authorise **Andrew Edward Dowling, Junior** of **Groydon, North Queensland**

to occupy until 31st December next, and thereafter from year to year, so long as the rent fixed from time to time in terms of "*The Land Acts, 1910 to 1935*," is punctually paid, or until this License is determined in the manner hereinafter mentioned, the lands in the abovementioned District more particularly described in the Schedule hereto. The License shall be determinable at any time with respect to the whole or any specified part of the said land by three months' notice given by the Minister to the Licensee subject to the provisions of "*The Land Acts, 1910 to 1935*," as to abatement of rent. Provided always that the whole or any part of the said land may at any time be notified to be open for selection under "*The Land Acts, 1910 to 1935*," and ~~and the~~ *Prickly-pear Land Acts, 1932 to 1935*," or be reserved under the said Acts, or be leased under the said Acts, and if the whole or any part of the said land is so selected, leased, or reserved, the License shall as to the whole or such part thereof, as the case may be, and subject to the said provisions as to abatement of rent, be thereby forthwith determined.

Special Condition: **N11**

Given under my hand the

Twentieth day of *July* 1945

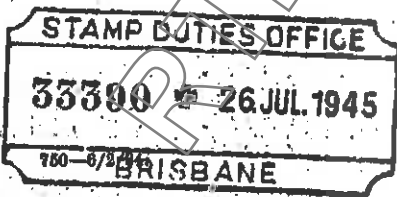

A Jones
Secretary for Public Lands.

[SEE BACK.]

PROVISIONAL LICENSE ISSUED 4 Nov 1991

CROWN COPYRIGHT RESERVED

Scale 1:250,000

PLAN 0 L 7095

7/26/7/88
19a

Kormenton

Notification: 4th July, 1941

of Gazette: 22 and 23

County: Surrey

Parish: Peccreumont

Portion or Name of Block: Lot 712 on Plan 01295

Area: 27 square miles

DESCRIPTION.

Commencing at the north-west corner of Littleton Holding (being a point eleven chains sixty-four links west and forty-one links north from a tree marked broad-arrow over B over N), and bounded thence by that holding south about two miles fifty chains, by lines west about eleven miles sixteen chains, north about two miles seventy-six chains and east about three miles, by S.L. 521 south about one mile seventy chains, east about three miles and north about one mile seventy chains, and by lines east about five miles fourteen chains and south to the point of commencement; - exclusive of any mining tenures.

Consequent upon the introduction of new system mapping, the area of the within-described license has been amended to 68 km² as from 1st January, 1975. The annual rent remains unaltered.

Registrar of Dealings

TRANSFER of the licensee's interest in the within-described license to JOHN EDWARD PICKERING as trustee for the Table Top Trust

Registered: 1.3 FEB 1981

Registrar of Dealings

IN terms of Regulation 41A (1) of the Land Regulations, the description of the Land comprised in the within lease is amended to lot 712 on plan 01295

Registrar of Dealings

Queensland Trustees Limited as personal representative of John Edward Pickering deceased the trustee of The Table Top Trust

is now the registered licensee of the within described license.

TRANSMISSION BY DEATH No. K783877J

PRODUCED 24 Sep 1991

REGISTERED

25 NOV 1991

REGISTRAR OF DEALINGS

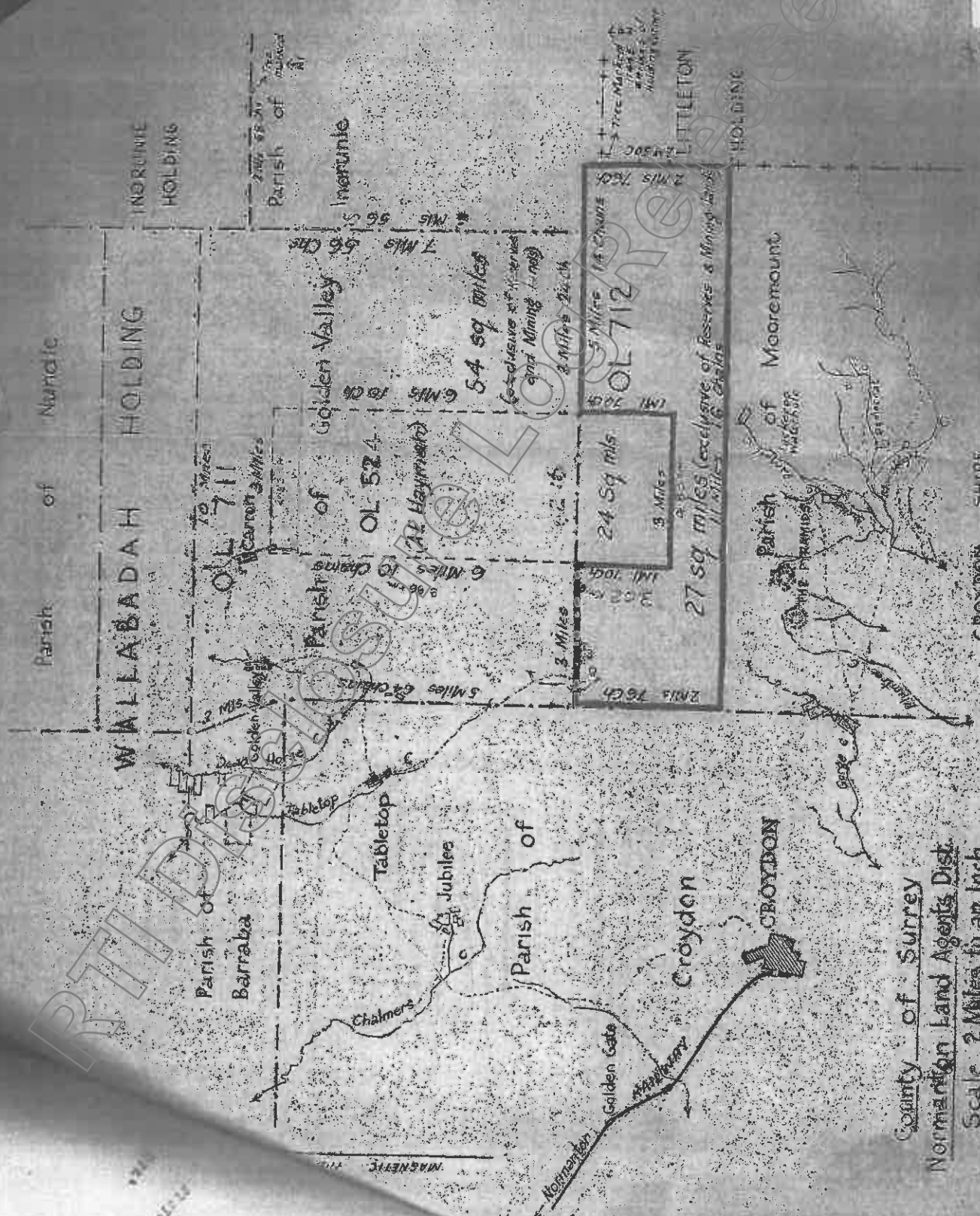

County of Surrey
 Normanston Land Agents Dist.
 Scale 2 Miles to an Inch

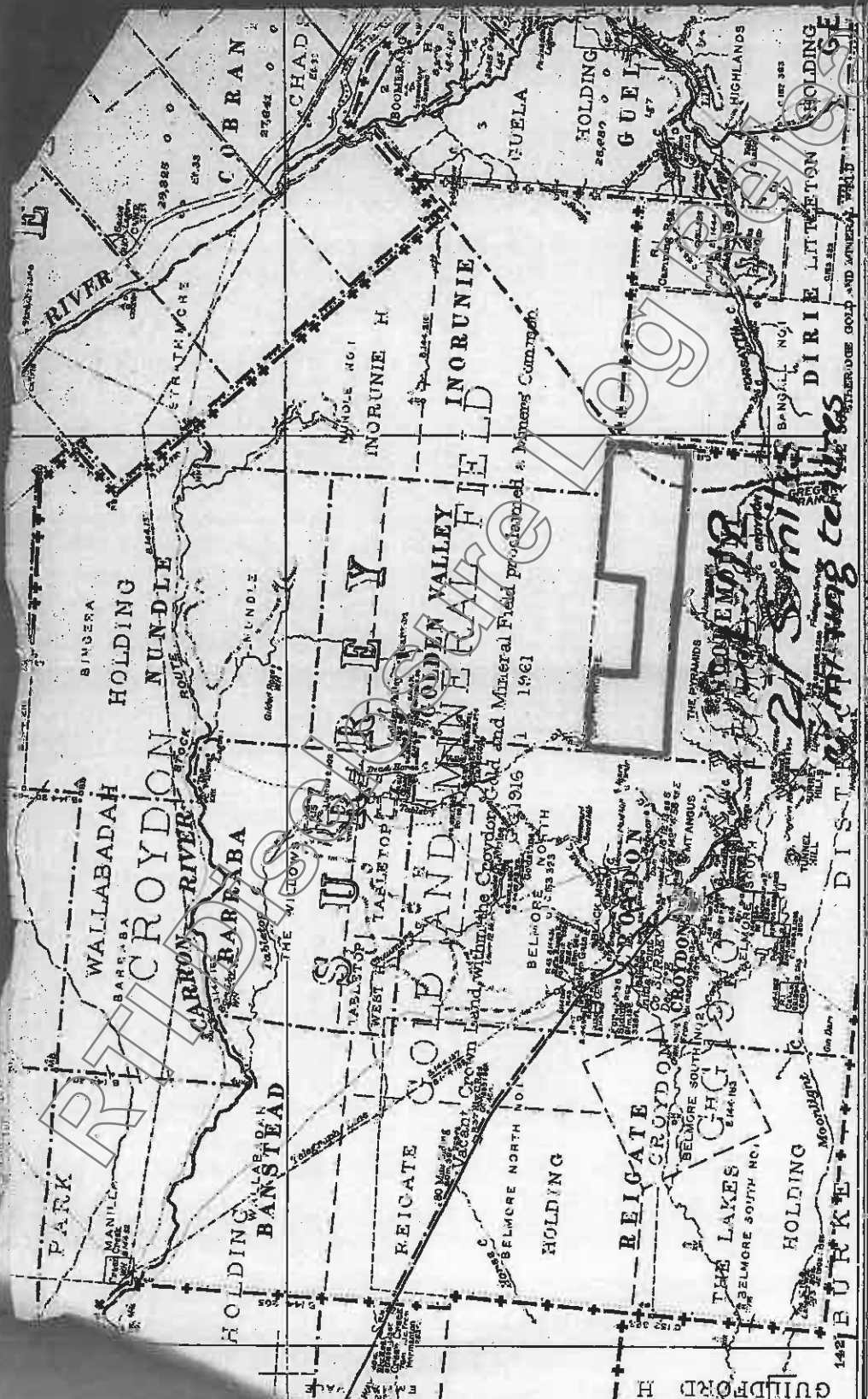

Scale: - 4 miles to an inch

County Names: DARRIN, DARRAN, BANANA, ARCHER, YGL 2

Parish: DARRIN, BANANA, ARCHER, YGL 2

Holding: DARRIN, BANANA, ARCHER, YGL 2

Block: DARRIN, BANANA, ARCHER, YGL 2

Forest Grazing Lease: DARRIN, BANANA, ARCHER, YGL 2

Post-1914 District Boundary: DARRIN, BANANA, ARCHER, YGL 2

State: DARRIN, BANANA, ARCHER, YGL 2

County: DARRIN, BANANA, ARCHER, YGL 2

District and Holding: DARRIN, BANANA, ARCHER, YGL 2

County and Holding: DARRIN, BANANA, ARCHER, YGL 2

Rabbit Board Fence: DARRIN, BANANA, ARCHER, YGL 2

C.F. denotes Grazing Farm, C.H. denotes Grazing Home

Astronomical Stations A, B, C, D, E, F, G, H, I, J, K, L, M, N, O, P, Q, R, S, T, U, V, W, X, Y, Z

Keys to Adjoining Sheets

New Issue	100	101	102	103	104
Old Issue	98	97	96	103	104

103 104

- WATER**
1. Parrot Dam
 2. Cedric's Dam
 3. No Name Dam
 4. Carron Dam
 5. Mulligan's Mill
 6. Tabletop Dam
 7. Melrose Dam
 8. Milne Dam
 9. Mountain Maid Shaft
 10. Homeward Bound Dam
 11. La. Ruise Mine
 12. G. Lenoir Mine

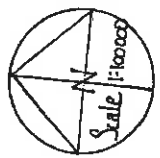
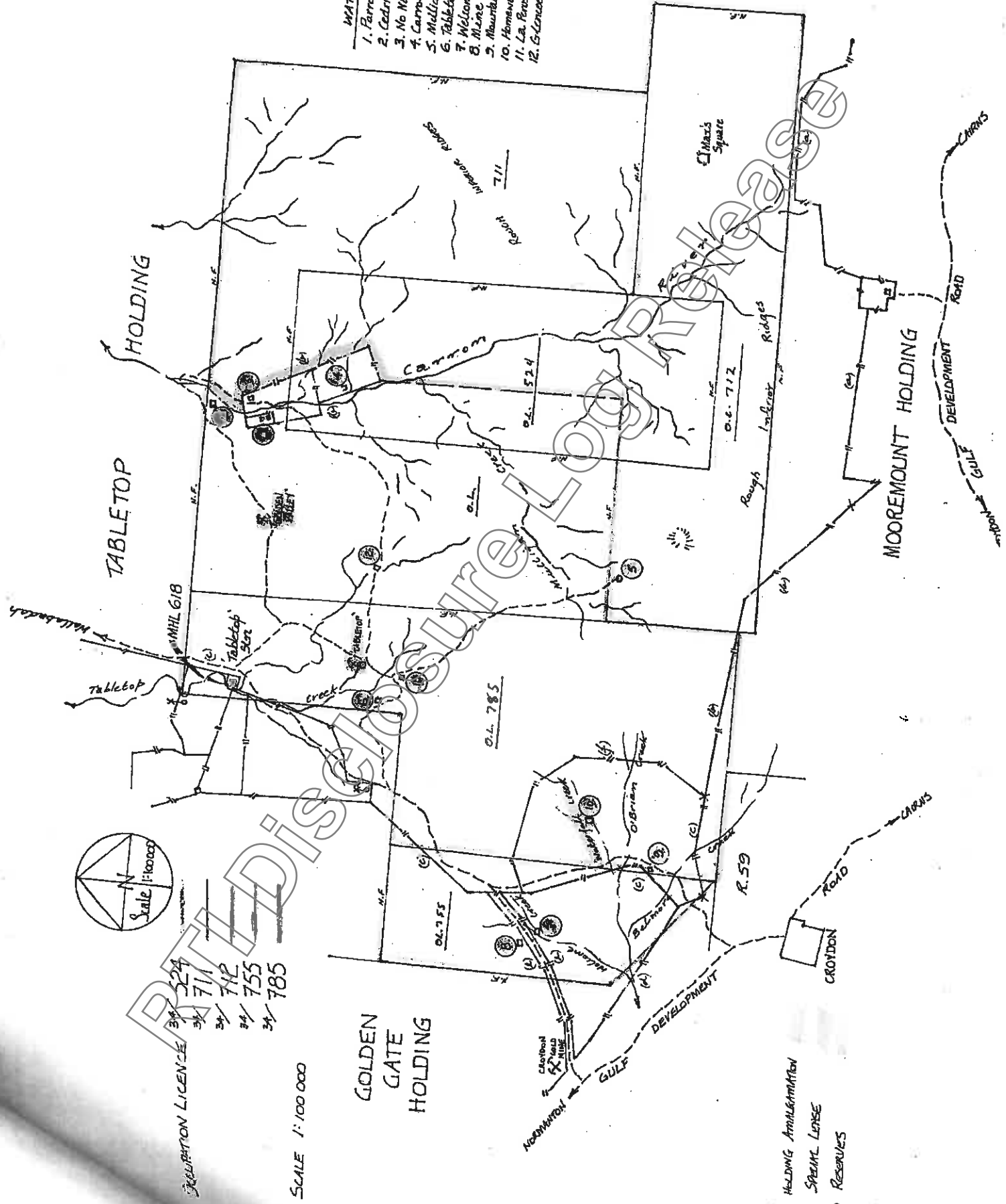

34/ 524
 34/ 711
 34/ 712
 34/ 755
 34/ 785
 EXPLANATION LICENCE
 SCALE 1:100 000

Proposed Holding Amalgamation
 Proposed Special Lease
 Proposed Reserves