

QUEENSLAND STAMP DUTY PAID
AMOUNT \$ 1580.00 ON 8/7/92
13A - 5911

8/7/92

LAND ACT 1962

[Redacted]

(6) Personal information

ACCEPTANCE OF OFFER TO PURCHASE LAND IN TERMS OF SECTION 207 OF THE LAND ACT 1962

We, Day's Proprietary Limited
of 162, ENTERPRISE DRIVE, BEAUDESERT 4285
being the Company to whom an offer has been made in terms of the abovementioned Section of the Land Act 1962 of purchase of the land described hereunder, **HEREBY GIVE YOU NOTICE** that We accept such offer at the purchasing price mentioned hereunder.

PARTICULARS OF LAND.

TENURE: Special Lease No. 06/44792
DESCRIPTION OF LAND: Lot 162 on Plan WD 4671
PARISH: Logan
AREA: 5140 square metres
PURCHASING PRICE: \$72,000.00

RTI/DL RELEASE - DNRM

DATED at Beaudesert
this 7th day of July 1992

[Signature of Purchaser]:

[Redacted Signature]
sch4p4(6) Personal information
Seal

Witness

[Redacted Witness Name]
sch4p4(6) Personal information

Sawston

SURRENDER

KNOW ALL MEN BY THESE PRESENTS, that DAY'S PROPRIETARY LIMITED being the lessee of Special Lease No.06/44792 in the Land Agent's District of Brisbane (Volume 7551 Folio 68).

County of : Ward
Parish of : Logan
Lot No. : Lot 162 on Plan WD 4671
Area : 5140 square metres

do hereby surrender and transfer to Her Sovereign Majesty Queen Elizabeth the Second all my right, title and interest in and to the said Special Lease for the purpose of:-

*Delete Whichever is not Applicable

- (a) ~~being granted a freehold title (Deed of Grant) over the land comprised in Lot 162 on Plan WD 4671 registered in the Division of Information.~~
- (b) purchasing on terms by way of a demise the land comprised in Lot 162 on Plan WD 4671 registered in the Division of Information.

in terms of Section 207 of the Land Act 1962

In witness whereof ~~have hereunto set hand at~~ *THE COMMON SEAL OF DAY'S PTY LTD ACN 009 816 139*
~~WAS HEREBY AFFIXED BY THE GOVERNING DIRECTOR, STANLEY DAY~~
this *seventh* day of *July* 19*92*

Signed by the said

in my presence sch4p4(6) Personal information

J.P.
Solicitor

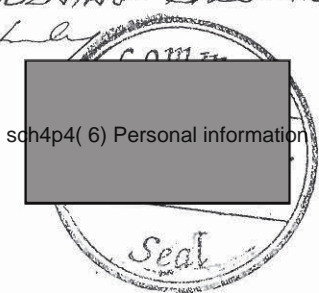

N.B. This Surrender must be endorsed with the consent of any Mortgagee and must be accompanied by the relevant Instrument of Lease.

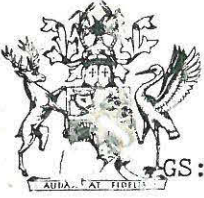

Land Administration Commission

Department of Lands
Land Administration Building,
130-148 George Street, Brisbane

Address mail to:
The Secretary, P.O. Box 168,
BRISBANE NORTH QUAY, Q. 4000
Telex: Q LANDS AA41412. DX 229 Bris.

GS:KG

Mr W.T. Atthow,
Solicitor,
William Street,
BEAUDESERT. Q. 4285

Enquiries to: TMD 1 - Mr Simpson

Telephone (07) 22 46995

Your Ref: RBA

Our Ref: SL 06/44792

Date: 30th June, 1986

Dear Sir,

RE: Special Lease No.06/44792
Lot 162 on plan Wd4671

I refer to your letter of the 19th March, 1986 regarding the above and I advise that the lease is registered in the name of Alford Refrigeration Industries Pty Ltd, and subject to Memorandum of Mortgage No. 204700 to Commonwealth Development Bank of Australia.

Any application for an extension of time to enable compliance with outstanding conditions of the lease will be considered by this Department when the lease is registered in the name Day's Pty Ltd.

Yours faithfully,

sch4p4(6) Personal information

sch4p4(6) Personal information
cretary.

RTI DL RELEASE - DIRM

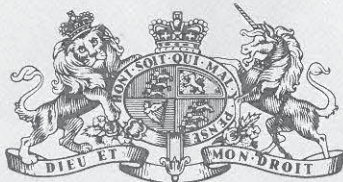

QUEENSLAND

SPECIAL LEASE PURCHASE FREEHOLD LEASE
Land Act 1962

Elizabeth the Second, by the Grace of God, Queen of Australia, and Her other Realms and Territories, Head of the Commonwealth-

To All to whom these Presents shall come, Greeting:

WE, with the advice of the Executive Council, under Section 207 of the Land Act 1962, lease as Special Lease Purchase Freehold all that parcel of land described in Schedule 1, for the term of years specified in Schedule 2, to the person described in Schedule 3,

SUBJECT TO -

- (a) the payment of the purchasing price specified in Schedule 2 by annual instalments under the Land Act 1962; and
- (b) the reservations specified; and
- (c) the covenants specified; and
- (d) the conditions specified in Schedule 4; and
- (e) such other reservations and conditions as may be contained in and declared by the laws of the State.

Specified Reservations -

- (a) all minerals (as defined by the Mineral Resources Act 1989) on and below the surface of the land; and
- (b) the right of access for the purpose of searching for and working any mines (as defined by the Mineral Resources Act 1989) in any part of the land; and
- (c) all petroleum (as defined by the Petroleum Act 1923) on or below the surface of the land; and
- (d) all rights of access for the purpose of searching for and for the operations of obtaining petroleum in any part of the land, and all rights of way for access and for pipe-lines and other purposes requisite for obtaining and conveying petroleum in the event of petroleum being obtained in any part of the said land.

Specified Covenants

On compliance with section 207 of the Land Act 1962 the lessee is entitled to a grant in fee simple of the land comprised in the lease.

IN TESTIMONY WHEREOF, We have caused this Our grant to be sealed with the Seal of the State of Queensland.

WITNESS Our Trusty and Well-beloved Her Excellency LENEEN FORDE, Governor in and over the State of Queensland and its Dependencies, in the Commonwealth of Australia, at Government House, Brisbane, in Queensland aforesaid, this Seventeenth day of December, in the forty-first year of Our Reign and in the year of Our Lord One thousand nine hundred and ninety-two.

SCHEDULE 1 - Description of Land

SLPF No: 06/2160	Region South Coast	L.A.D. Brisbane
Lot 162 on Plan WD4671		
County Ward	Parish Logan	
Area .5140 hectares		

sch4p4(6) Personal information

Department of Lands References:-
Previous File Ref: SL44792

Section 207

SCHEDULE 2 - Term and day of beginning of Lease and purchasing price

Term: 10 years commencing on 8 July 1992

Purchasing Price \$72,000

SCHEDULE 3 - Lessee

DAY'S PTY LTD

SCHEDULE 4 - Specified Conditions

Nil

RTI DL RELEASE - DNRM



TRAVERSES ETC.		
LINE	BEARING	DIST.
5-6	162°43'	10
6-Y	262°10'12"	833.785 Cal
Y-Z	124°34'45"	138.91

FOR OPENING NOTIFICATIONS SEE BACK

POR NO	FARM NO
163	5L 44470 L
162	6L 44792 L

PERMANENT MARKS			
P.M.	BEARING	DIST.	NUMBER
14-OPM	305°40'	0.86	34521
Y	0 Perm Mk at stn		34522

Information marked 'ORIG' compiled from Wd 4093 in the Office of the Surveyor-General



L. KEON 'TIN OLIVES, Surveyor-General, being an approved person in the Evidence Act 1977 certifies that this transparency was made as a part in my custody or under my direct supervision and control. Dated at Brisbane this 2nd day of MAY 1984. L.K.O.

DRAWING OF PLAN MUST BE RESTRICTED TO THE SPACE INSIDE THE BLUE LINES

Area of New Road (13-11-A-B)

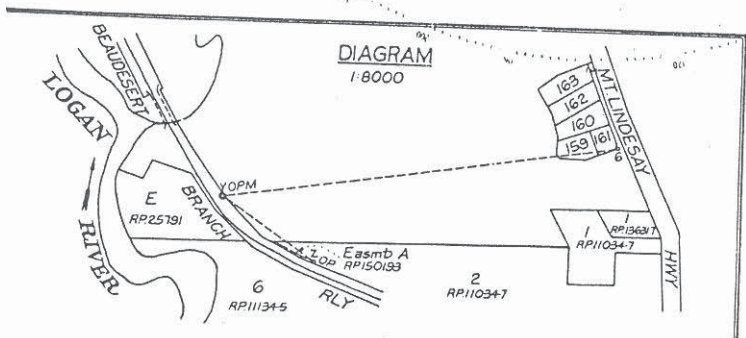

For remarking of Por 163 see Instruction 82 K1/86 - R.T. Hume 3 6 82

REFERENCE MARKS			
STN	TO	BEARING	DIST.
1	O/P	74°21'	1.0
2	P/n	59°46'	1
3	O/P	61°30'	1
4	1	72°43'	1
7	P/n	241°30'30"	0.986
10	O/P	180°31'	1.0
11	P/n	241°20'30"	1.025
12	1	239°46'0"	1.0
13	1	231°56'	1

BEAUDESERT INDUSTRIAL ESTATE

SURVEY PLAN									
INSTRUCTIONS					MERIDIAN OBSERVATIONS				
AUTHORITY	INSTRUCTIONS	DRAWN	EXAMINED	CHECKED	PASSED	CHARTED	R.W.	STN	VARIABLES
	77 K1/534-16-12-77	R.P.S.	I.R.M.	PE	C. S.C.	R.W.	2.3.82		E.A.M.
ADJUSTMENTS									
AUTHORITY	POR	PREV. AREA	DRAWN	EXAMINED	CHECKED	PASSED	CHARTED		
P.M. CROWN COPYRIGHT RESERVED									
CAM					wide Wd 4093				
SCALE 1:1000					SURVEYED BY R.T. Hume				
DATE 13-1-78					FIELD NOTES 77 K1/534 2 2 78				
Portions 162 & 163 PARISH OF LOGAN County of Ward, L.A. District of Brisbane									

RTI DL RELEASE - DNRM

ENDORSEMENT: Transfers, Mortgages, Etc., Registered

RTI DL RELEASE - DNRM

X SL. 44792.

W.T. ATTHOW
SOLICITOR
TELEPHONE 41 2292
RESIDENCE 41 2329
P.O. BOX 33
ASSOCIATE:
R.B. ATTHOW
RESIDENCE 41 2416

DEPT. OF LANDS
WILLIAM STREET
BEAUDESERT
QLD. 4285
11926
Ref. RBA
BRISBANE
9th March, 1987
11 MAR 1987
10 MAR 1987
BRANCH
J.P.W.

The Secretary,
Land Administration Commission,
P.O. Box 168,
BRISBANE NORTH QUAY Q. 4000

Dear Sir,

Re: Day's Pty Ltd purchase from
Commonwealth development bank.
Your reference: SL06/44792

I refer to the above matter and would be pleased if you could advise me of the current situation regarding registration of the Transfer in the above mentioned matter.

Yours faithfully,
W.T. ATTHOW

Pe: sch4p4(6) Personal information

RTI DL RELEASED BY DIAM

sch4p4(6) Personal information

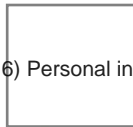

slwp as mtd.

2-19.3.87

DUPLICATE
LAND ADMINISTRATION COMMISSION

Department of Lands

Brisbane, 12-3-1987

Communications to be addressed to
The Secretary,
Land Administration Commission

to Mr. CONTER
e 2 1 7575 DX229

Memorandum on Dealings

Holding	District	Nature of Dealing	Names of Parties
44792	BRISBANE	TRANSFER	CDB AS MORTGAGEE EXERCISING POWER OF SALE to DAY'S Pty Ltd.

Application lodged: 16.5.86. Your ref.: RBA Letter of: 16.9.86.

Registration of the above dealing still requires any information and undertaking as set out in my requisition of 4th September, 1986 (returned herewith).

I would point out that Department's letter of 30th 1986 states that any application for an extension to enable compliance with outstanding conditions will be considered by this Department when lease is registered in the name of Day's Pty Ltd.

RTI RELEASE - DNRM

sch4p4(6) Personal information

W. T. Atthaw
P.O. Box 33,
Beaudesert, Q. 4285

BRISBANE BRANCH

12 JUN 1987

REGISTRATION BRANCH

sch4p4(6) Personal information

sch4p4(6) Personal information

2.3.87

DEPT. OF LANDS

SL 44792

18 SEP 1986

49624

18 SEP. 86 304/N

BRISBANE

355

BRANCH

HOW
OR
41 2292
41 2329
X 33
ATE:
HOW
41 2416

WILLIAM STREET,
BEAUDESERT,
QLD. 4285

Ref: RBA

16th September, 1986.

Secretary,
Land Administration Commission,
P.O. Box 168,
RISBANE NORTH QUAY Q. 4000

Dear Sir,

Re: Day's Pty. Ltd. purchase from Commonwealth
Development Bank.
Your reference: SL 06/44792.

I refer to your memorandum dated the 10th instant and advise
as follows:-

1. The correct name of the Transferee company is Day's Pty. Ltd. as shown on the Certificate of Incorporation. The "Beaudesert" shown on the Common Seal is purely decorative.
2. I enclose herewith photocopy of letter from your Department regarding application for extensions of time regarding the outstanding conditions. I advise that my client company is fully aware of their responsibilities under the lease.

I have completed the attestation clause for the company and I trust the transfer can now be registered.

I enclose herewith original memorandum, Transfer of Lease and photocopy of letter from Land Administration Commission.

Yours faithfully,
W.T. ATTHOW

sch4p4(6) Personal information

LAND ACT 1962-19

Transfer of Lease, License or Purchase

(NOTE: FORM 61 PROVIDES FOR TRUSTEES)

1. Schedule of tenure or license being transferred:

Land Agent District: Brisbane ✓
 Type of Tenure or License: Special Lease ✓
 Register No.: 06/44792 ✓
 (name may also be used for pastoral lease)
 County: Ward ✓
 Parish: Logan ✓
 Portion: 152 ✓
 Section: 203(a) ✓
 Allotment:
 Lot:
 On Plan:
 Area: 5140 m² ✓

REGISTRATIONS SECTION
 sch4p4(6) Personal information
 410
 S1
 74448

Dealing No. 628332
 Received in the Lands Dept.
 16/5/86 at 4:10 o'clock

2. Memorandum of mortgages, sub-leases, charges or other encumbrances:

NIL

3. I, (i)

DEVELOPMENT
 COMMONWEALTH/BANK OF AUSTRALIA of 215 Adelaide Street, Brisbane in the State of Queensland as mortgagee
 UNDER MEMORANDUM OF MORTGAGE No. 20470

sch4p4(6) Personal information

being the lessee, licensee or purchaser of the lease, license or purchase described in paragraph 1, subject to all such mortgages, subleases, charges or other encumbrances as are notified by memorandum set forth in paragraph 2, in consideration of the sum of \$ 50,000.00 (made up of \$ 5000.00 for lease, license or purchase, \$ NIL for stock, and \$ 45000.00 for improvements), this day paid to me by (ii) DAYS PTY. LTD.

sch4p4(6) Personal information

of (iii) 29 Anna Street, Beaudesert in the State of Queensland

the receipt of which sum I hereby acknowledge, hereby transfer and assign to the said (iv)

DAYS PTY. LTD.

sch4p4(6) Personal information

AND THE ESTATE OR INTEREST OF ALFORD REFRIGERATION INDUSTRIES PTY LTD.
 estate or interest in the said lease, license or purchase.

Dated at BRISBANE, this 21st day of April, 1986.

sch4p4(6) Personal information

COMMONWEALTH DEVELOPMENT BANK OF AUSTRALIA
 By Its Attorney
 MORTGAGEE UN
 MORANDUM
 MORTGAGE N
 204700
 EXERCISE
 NEIL VINCENT DUNDON POWER C
 SALE

sch4p4(6) Personal information

Witness Signature of Transferee

[If a corporation, to be executed under its common or official seal]

I, as the proposed transferee declare that I seek to acquire the said lease, license or purchase and that I am willing and able to hold and use the same in accordance with the laws and regulations in force for the time being and subject to the conditions of lease, license or purchase.

sch4p4(6) Personal information

Dated at Beaudesert, this 15th day of April, 1986

GIVEN UNDER THE COMMON SEAL OF
 DAYS PTY. LTD. BY AUTHORITY OF A
 BOARD OF DIRECTORS
 STANLEY RAYMOND D
 DAY MANAGING
 DIRECTOR WHO
 PARTIES THAT

sch4p4(6) Personal information

sch4p4(6) Personal information

STANLEY RAYMOND D
MANAGING DIRECTOR

Witness Signature of Transferee

[If a corporation, to be executed under its common or official seal]

HE IS THE PROPER OFFICER TO FIX SUCH SEAL.

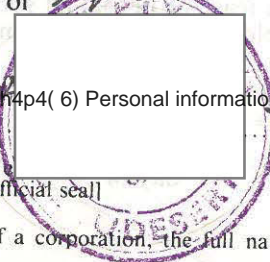

- NOTES:
- (i) State Christian names and Surname in full in block letters; if a corporation, the full name of the corporation; if joint holders all must be shown as registered on the title.
 - (ii) State Christian names and Surname in full in block letters; if a corporation the full name of the corporation.
 - (iii) State address for service of notices resulting upon this transfer.
 - (iv) State Christian names and Surname in full in block letters; if a corporation the full name of the corporation; if two or more persons are to hold jointly, state the type of tenancy, i.e. as joint tenants or as tenants in common, and if the latter, the interest to be held by each transferee.

RT 14-334 the transferee is administrator, executor or trustee, etc. the form should be altered to cover the circumstances of the case.

4. Declaration by transferee:

I declare that—

- * (a) I am of the full age of _____ years and that my date of birth is _____, 19__.
- * (b) The transferee is a company/corporation that has the power to hold land in the State and transferee is—
 - * (i) a company/~~recognized company/recognized foreign company/registered foreign company~~ within the meaning of the Companies (Queensland) Code;
 - * (ii) a body corporate that is incorporated or formed under # _____;
 - * (iii) a statutory corporation that is constituted by # _____.

Signed this 15th day of April, 1980

sch4p4(6) Personal information

SEAL OF DAVID'S PTY LTD
BY AUTHORITY OF THE
RESOLUTION OF THE
BOARD OF DIRECTORS
IN THE PRESENCE OF
STANLEY RAYMOND DAY
MANAGING DIRECTOR WHO
CERTIFIES THAT HE IS THE
PROPER OFFICER TO FIX SUCH
SEAL

sch4p4(6) Personal information

Witness

sch4p4(6) Personal information

sch4p4(6) Personal information

sch4p4(6) Personal information

STANLEY RAYMOND DAY
MANAGING DIRECTOR

- * Delete whichever is not applicable.
- # Insert title of Act under which formed or constituted.

[NOTES:

- (i) If a company or corporation (other than a statutory corporation), attach a certified copy of the certificate of its incorporation or registration in its place of incorporation or formation or a document of similar effect. (Certification to be by the relevant registering authority).
- (ii) The Registrar of Dealings will dispense with the requirement to lodge documentary evidence of the incorporation of a company or corporation referred to in 4 (b) (i) or (ii), where the document is already available in the Brisbane Office of the Department of Lands in respect of a previous dealing involving the transferee. The transferee should provide particulars of the previous dealing, and the Departmental file reference, if known.]

5. Additional declaration by transferee of—

- (A) A PREFERENTIAL PASTORAL HOLDING, GRAZING HOMESTEAD PERPETUAL LEASE, PERPETUAL LEASE SELECTION, AGRICULTURAL FARM OR GRAZING HOMESTEAD FREEHOLDING LEASE: OR
- (B) PERPETUAL TOWN LEASE, PERPETUAL SUBURBAN LEASE OR PERPETUAL COUNTRY LEASE (INCLUDING NON-COMPETITIVE LEASES).

I declare that I seek to acquire the holding described in paragraph 1 in order that I may hold and use the land for my exclusive benefit according to law, and not as trustee, agent or servant of another person.

Signed this _____ day of _____, 19__

Witness

Declarant [If joint transferees, all must sign].

6. Additional declaration by transferee of a perpetual town lease or perpetual suburban lease:

I declare that the holding described in paragraph 1, together with all other holdings held by me, as either perpetual town lease or perpetual suburban lease in the city, town or township in which I seek to acquire the said holding do not exceed in number six allotments or portions.

I am at present the lessee of Perpetual Town Lease No. # _____ Perpetual Suburban Lease No. # _____

Signed this _____ day of _____, 19__

Witness

Declarant [If joint transferees, all must sign].

[NOTE: # include all held in Queensland, if NIL held write NIL.]

7. Additional declaration by transferee of a pastoral holding, pastoral development holding, preferential pastoral holding, stud holding, grazing homestead perpetual lease, perpetual lease selection, agricultural farm or grazing homestead freeholding lease:

I declare that I hold the following—

(a) country land for an estate in fee-simple

D/G or C/T	Vol.	Fol.	Por. No. or Lot on Plan	Parish	County	Area	Interest held	If grazing estimated Carrying Capacity	Office Use

#(b) leasehold land that is pastoral holding, pastoral development holding, preferential pastoral holding, stud holding, grazing homestead perpetual lease, perpetual lease selection, agricultural farm or grazing homestead freeholding lease—

Tenure	Registration No. (and name if Pastoral Lease)	District	Area	Interest Held	Office Use

[NOTE: # if NIL held write NIL.]

Signed this day of , 19 .

.....
Witness

.....
Declarant [If joint transferees, all must sign].

RTI DL RELEASE - DNRM