

26th February, 1975.

Dear Sirs,

re: Mining Lease No. 1183 - Brisbane
Brickworks Limited

With reference to previous correspondence I have to inform you that the Hon. the Minister on 20th February 1975 recommended to the Governor in Council that Mining Lease No. 1183, Brisbane be granted.

Also, on 20th February 1975 the Governor in Council granted Mining Lease No. 1183, Brisbane for a term of twenty-one (21) years at a rental of two dollars (\$2.00) per acre per annum subject to all covenants and conditions applying to all Mining Leases and subject to the following special conditions:-

1. The method of mining shall be such as may be approved from time to time by the Minister and/or his officers.
2. Mining shall be so conducted as will cause the least possible hazard or nuisance to the public in adjacent areas.
3. Mining shall be so conducted as will not cause ground subsidence beyond the lease perimeter.
4. Tree and a shrub cover shall be planted within the lease perimeter to such extent as may be required by the Minister and/or his officers in order to obscure the mining operations from the public view.
5. Water shall not be allowed to accumulate within the lease perimeter.

Yours faithfully,

49-Sch4 - Signature

(E. K. HEALY)

Under Secretary.

49-Sch4 - Signature

Messrs. Cannan & Peterson,
Solicitors,
G.P.O. Box 407,
BRISBANE. QLD. 4001

49-Sch4 - Signature

96

**DEPARTMENT OF MINES AND ENERGY
BRISBANE DISTRICT OFFICE - SOUTHERN REGION**



DEPARTMENT
OF MINES
AND ENERGY

OUR REF.

YOUR REF.

CONTACT OFFICER: Mr Ken Goodwin

TELEPHONE: (07) 3237 1201

FAX: (07) 3221 1452

Boundary Court, Level 1, 55 Little Edward Street, Spring Hill QLD 4000
P.O. Box 839, Spring Hill QLD 4004



QUEENSLAND
GOVERNMENT

08 April 1998

The Austral Brick Company Pty Ltd
c/- Kershaw & Co
9 McInroy Street
TARINGA QLD 4068

Dear Sir / Madam

MINING LEASE NUMBER 1156

The Governor in Council on 2 April 1998, having considered the standard criteria as prescribed under Section 44 of the Environmental Protection Act, renewed Mining Lease Number 1156 for a further period to expire on 28 February 2021.

Please find the following attached:-

- Register printout.
- Graphic sketch showing the boundaries of the lease.
- Plain English version of the conditions of the Mineral Resources Act and Regulations.

Please note that as from 1 January 1998 rent will payable on this renewal at the rate prescribed, currently \$34.05 per hectare. You will automatically receive a rent notice towards the end of this and each year to define the amount of rent payable, in advance, for the following twelve (12) months. Separate advice will, in due course, be sent to you regarding any adjustments to rental from the expiry date to grant of renewal.

This lease now forms part of Project PJM Number 50036, for which a security deposit of \$9240.00 in the form of a bank guarantee is held.

The Environmental Management Overview Strategy for this Project was approved on 9 July 1996. The Plan of Operations was accepted on 24 September 1996 and is due to expire on 24 September 2001. A fresh Plan of Operations must be lodged two (2) months before the expiry date.

The landowners must be notified of this renewal within the next twenty-eight (28) days.

Yours sincerely

49-Sch4 - Signature

K A Goodwin
Tenures Officer
Brisbane District Office

**RENEWAL CONDITIONS
(Plain English Version)**

RENT

All rental payments are paid yearly and in advance at the prescribed rate. You must pay before 31 December the rental due for the following year. If you do not pay your rent by 31 December, you must pay a penalty. An extra amount - 25 percent of your rent - will be added to your rental payment. Rent and penalty must be paid by 31 March or your lease could be liable for forfeiture.

ROYALTY

Each year you will receive a royalty return form. You must complete and lodge the form by 30 September for the year ended 30 June. You may be asked to submit a royalty return at different intervals to this. For example, gold producers lodge returns quarterly.

If you do not receive a royalty return form it is then your responsibility to contact this Department to obtain a form and verify your current postal address.

You are required to calculate how much royalty is due and enclose payment with your royalty return form. Your return will be assessed and if you are owed a refund, or if a further amount is due, you will be notified. Please keep proper books of accounts and documentary evidence to support the information in your royalty return.

You must submit a royalty return even if no mining took place during the year. If you do not lodge a return you could be subject to a penalty or your lease may even be cancelled.

Please send your completed return to the Department of Mines and Energy, GPO Box 194, BRISBANE, 4001.

HEALTH AND SAFETY

To protect the health and safety of everyone on the mine site you must comply with the Mines Regulation Act 1964. Please contact the Inspector of Mines in Brisbane before work commences. You need to notify the Inspector of Mines regarding the appointment of a Mine Manager and advise the Inspector when mining operations are either due to start or finish.

CONDITIONS OF ACT AND REGULATIONS

The conditions applying to a Mining Lease are contained in the Mineral Resources Act 1989 and Mineral Resources Regulations 1990. The Minister may also impose Special Conditions. Codes of Conduct and industry agreements also form part of the conditions of a Mining Lease. The conditions contained in the Act and Regulations are that you must -

- Carry out the operations for which the lease was granted in accordance with the Mineral Resources Act and conditions of the lease and for no other purpose;
- Submit plans of operations as requested by the Minister;
- Conduct mining activities in accordance with the accepted EMOS and current plan of operations;
- Submit an environmental audit for any plan of operations;

- Remove all equipment and plant on or in the land before the mining lease is terminated, for whatever reason, unless the Minister otherwise authorises;
- Not obstruct or interfere with any right of access at any time during the term of the mining lease by any person, unless they have the prior approval of the Minister in writing;
- Not assign, sublease, or mortgage the mining lease or any part hereof without the consent in writing of the Minister;
- Provide, as required, reports, returns, documents and statements;
- Provide, as required, materials obtained under the mining operations;
- Comply with the terms and conditions set for reserve land;
- Maintain the marking out of the land including survey pegs (boundary posts or cairns need not be maintained after the land has been surveyed);
- Make all compensation payments and comply with all compensation agreements;
- Pay rent;
- Pay royalties;
- Deposit security;
- Pay all local government rates and charges;
- Not spread parthenium weed seed or other weeds listed in the *Rural Lands Protection Act 1985*;
- Make sure your animals are restrained unless you have the written consent of the owner and have lodged the consent with the Mining Registrar and sent a copy to the Director-General;
- Not fire guns on occupied land unless you have the written consent of the owner and have lodged the consent with the Mining Registrar and sent a copy to the Director-General;
- Comply with the provisions of the Mineral Resources Act;
- Comply with any conditions as are prescribed; and
- Comply with any other conditions determined by the Governor in Council.

Tenure Id : ML 1156
 District : BRISBANE
 Previous Id : ML1183BRIS
 Lease Name : PREBBLE
 Status : GRANTED
 Sub-Status :

Pre-requisite Tenure Ids

-

Principal Holder

THE AUSTRAL BRICK COMPANY PTY LTD
 C/ KERSHAW AND CO
 9 MCINROY ST
 TARINGA QLD 4068

<u>Holder Names</u>	<u>Share %</u>	<u>Status</u>	<u>Deal In</u>	<u>Date Appv</u>	<u>Deal Out</u>
THE AUSTRAL BRICK COMPANY PTY LTD	100.0000	Current	1	25-MAY-88	
BRICKWORKS LIMITED	100.0000	Former		08-MAR-74	1

Marked Out Date and Time : 08-MAR-74
 Lodged Date and Time : 08-MAR-74 09:30 AM

Term Sought : 21 years
 Certificate of
 Application Issued : 10-JUL-74

Situated Within at Date Lodged

Area : 53.5100 Ha
 Surface Area : 49.3720 Ha

Plan Number : 36815

Surface Area Plan Numbers
 36815

Local Authorities

BRISBANE

Minerals / Purpose

CLAY--POTTERY / WHITE WARE
 CLAY--BRICK CLAY
 SHALE

Locality

ROCHEDALE

Date of Grant : 20-FEB-75
 Act Granted Under : MINERAL RESOURCES ACT 1989

Mining Leases - Public Search Report

Volume/Folio : /

Remarks

SURFACE AREA 1 45.02 HA (LOTS 1 & 2 RP 844169 SURFACE AREA 2 4.352 HA (LOT 4
3 RP207847)

Renewal Processes

Notice Issued :
Lodged : 20-SEP-95
Approved : 02-APR-98

<u>Term History</u>	<u>Commenced</u>	<u>Expiry</u>	<u>Years</u>
	01-MAR-75	29-FEB-96	21.00
	01-MAR-96	28-FEB-21	25.00

Area Units : 54.00
Rent Rate : \$34.05
Annual Rent : \$1838.70
Security Required :

	<u>Received</u> <u>Amount</u>	<u>Date</u>	<u>Refunded</u> <u>Amount</u>	<u>Date</u>
Application Fee				
Survey Fee	\$108.50	08-MAR-74		

Background Tenures

	<u>Land</u> <u>Usage</u>
LOT 1 ON RP844169 FREEHOLD PAR TINGALPA CO STANLEY	Mining
LOT 2 ON RP844169 FREEHOLD PAR TINGALPA CO STANLEY	Mining
LOT 43 ON RP207847 FREEHOLD PAR TINGALPA CO STANLEY	Mining
LOT 45 ON RP207847 FREEHOLD PAR TINGALPA CO STANLEY	Mining
LOT 42 ON RP207846 FREEHOLD PAR TINGALPA CO STANLEY	Access

Reserve No :

Reserve Name

Trustee Names

	<u>Received</u>	<u>Actioned</u>	<u>Expiry</u>
Operation Plan	18-SEP-96	24-SEP-96	24-SEP-01

Project : ROCHEDALE/REDLAND BAY

Site Contact

KERSHAW AND CO

Site Contact Address 9 MCINROY STREET
TARINGA QLD 4068

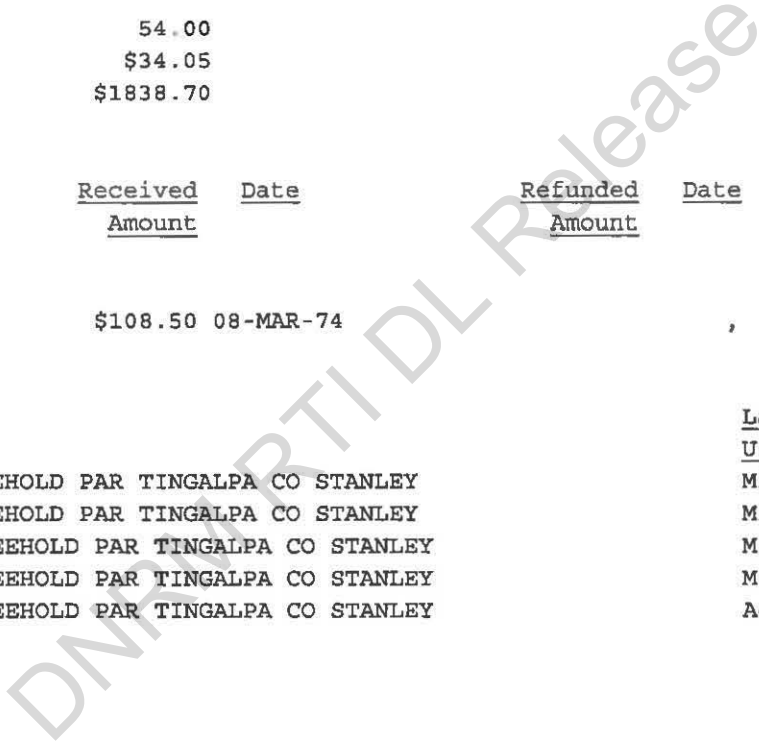

Mining Leases - Public Search Report

***** E N D ** O F ** R E P O R T *****

DNRM RTI DL Release

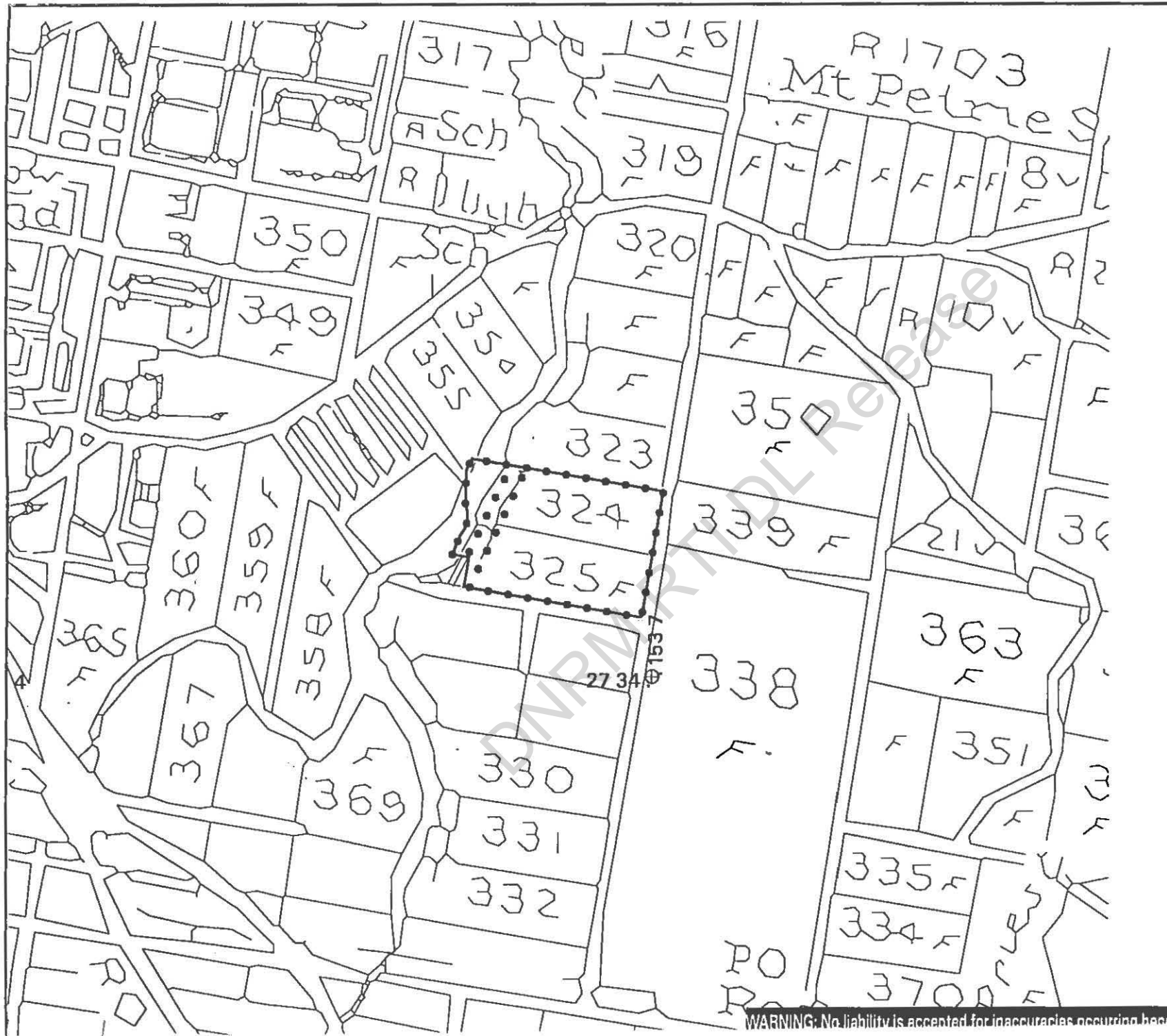

**DEPARTMENT
OF MINES
AND ENERGY**



**MINING LEASE
No. 1156**

Status: GRAN

Surface Area: PART

District:
BRISBANE

Principal Holder:
THE AUSTRAL BRICK COMPANY
PTY LTD

Background-lease:
(Supplied by applicant)
LOT 1 ON RP844169
FREEHOLD
LOT 2 ON RP844169
FREEHOLD
LOT 43 ON RP207847
FREEHOLD
LOT 45 ON RP207847
FREEHOLD

Background- Access:
(Supplied by applicant)
LOT 42 ON RP207846
FREEHOLD

Projection: Transverse Mercator Zone: 58

Scale 1:25 000



Date: 02/23/98.16:09:11.Mon

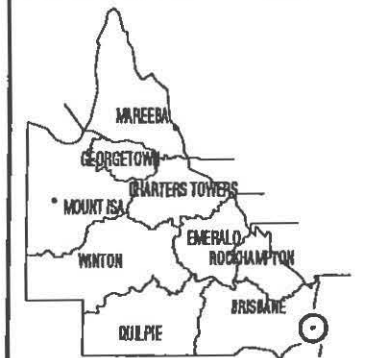

WARNING: No liability is accepted for inaccuracies occurring because of approximations between