

Map Produced from Queensland's IRTM System

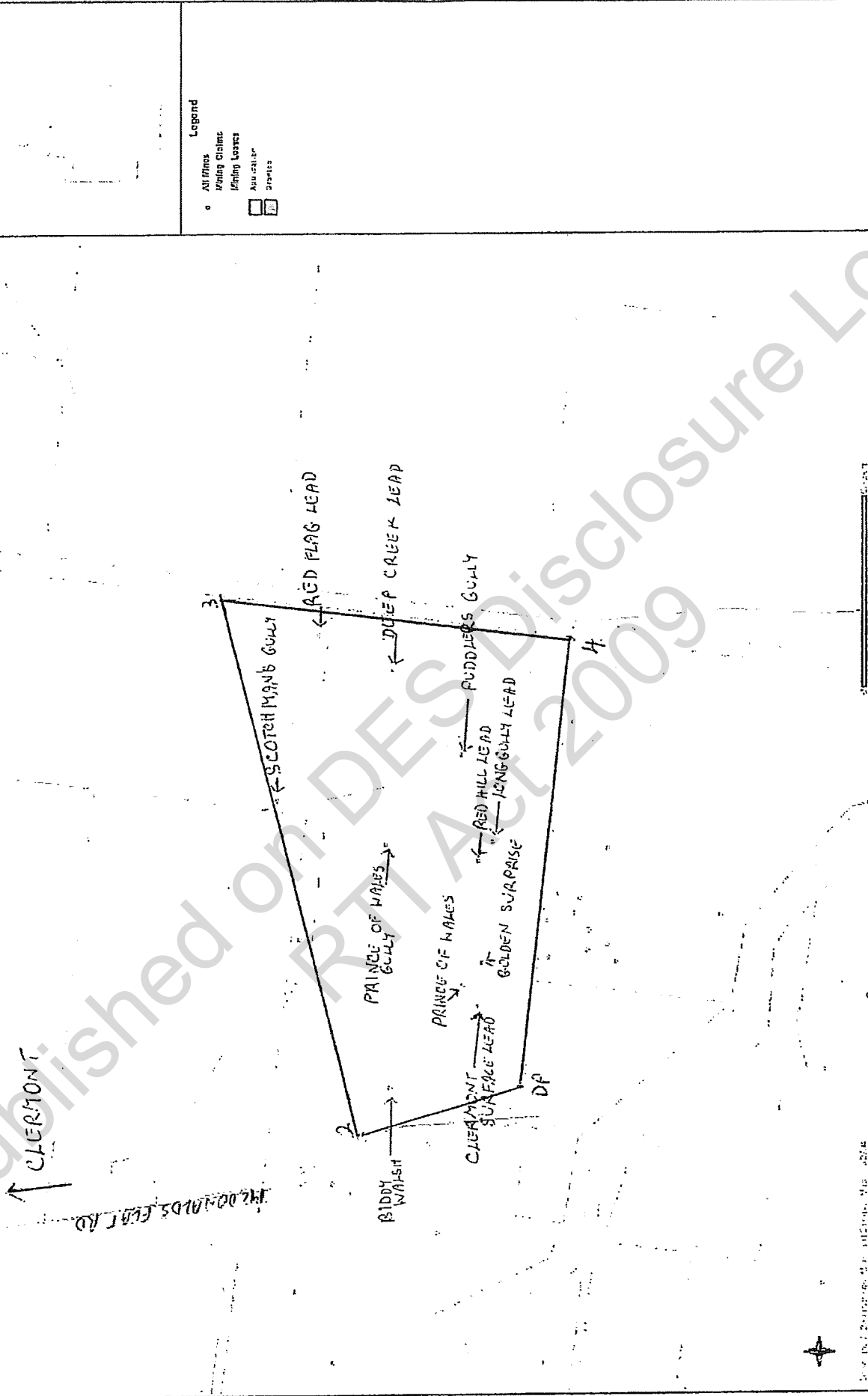

Scale 1:250,000

Queensland Department of Mines and Energy 2008. While every care is taken to ensure the accuracy of this product, the Department of Mines and Energy makes no representations or warranties about its accuracy, reliability, completeness or suitability for any particular purpose and disclaims all responsibility and all liability (including without limitation, liability in negligence) for all expenses, losses, damages (including indirect & consequential damage) and costs which you might incur as a result of the product being inaccurate or incomplete in any way and for any reason.

ENVIRONMENTALLY SENSITIVE AREAS

Requested By: REGINA.STARR@BIGPOUND.COM

Date: 22 Jun 08 Time: 10:48:53

Geocentric Datum of Australia 1994 : Albers Equal Area Projection



- Declared Irrigation Areas**
- Drainage Areas**
- River Improvement Areas**
- Stanhope DLA**
- State Forests**
- Timber Reserves**
- Coastal Management Control Districts**
- Dams and Weirs**
- TENURES**
- Mining Leases**
- Mining Claims**
- Mineral Development Licenses**
- Exploration Permits Coal**
- Exploration Permits Mineral**
- Authority To Prospect**
- Petroleum Leases**
- OTHERS**
- Roads**
- MagInfo Australia Pty Ltd 2009**
- Towns**
- Wild River Nominated Waterways**
- Wild River High Preservation Areas**
- Wild River Preservation Areas**
- Mahogany Glider Habitat**
- Disposal of Important Wetlands**
- Queensland**

- CATEGORY A**
- National Park**
- National Park (Scientific)**
- National Park (Cape York Peninsula Aboriginal Land)**
- National Park (Recovery)**
- Conservation Park**
- Forest Reserves**
- West Tropics World Heritage Area**
- Great Barrier Reef Marine Park Region**
- Marine Parks other than General Use Zones**
- CATEGORY B**
- Endangered Regional Ecosystems (Biodiversity Status)**
- Coordinated Conservation Areas**
- Remnant Sites**
- World Heritage Areas**
- General Use Zones of Marine Parks**
- Queensland Heritage Register Places**
- Cultural Heritage Registered Areas and DLA's other than Stanhopes**
- Special Forestry Areas**
- Fish Habitat Areas**
- Marine Plants**
- Koala Plan**
- CATEGORY C**
- Nature Refuges**
- Resource Reserves**
- Declared Catchment Areas**

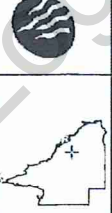

Queensland Government
Environmental Protection Agency

See page 2 for disclaimers and map notes.

LOCALITY DIAGRAM

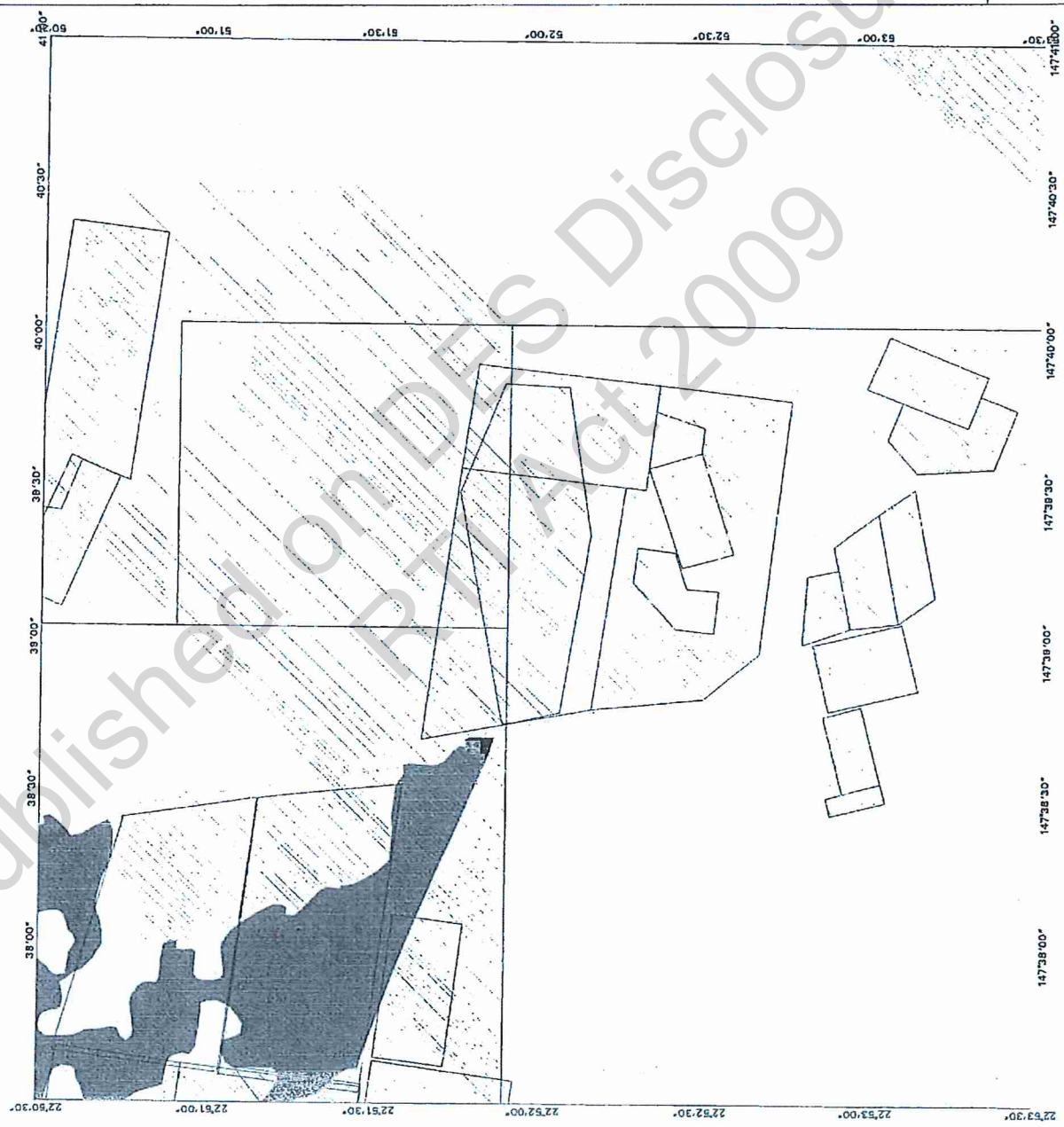

18 0360

Map Produced from Queensland's IRTM System

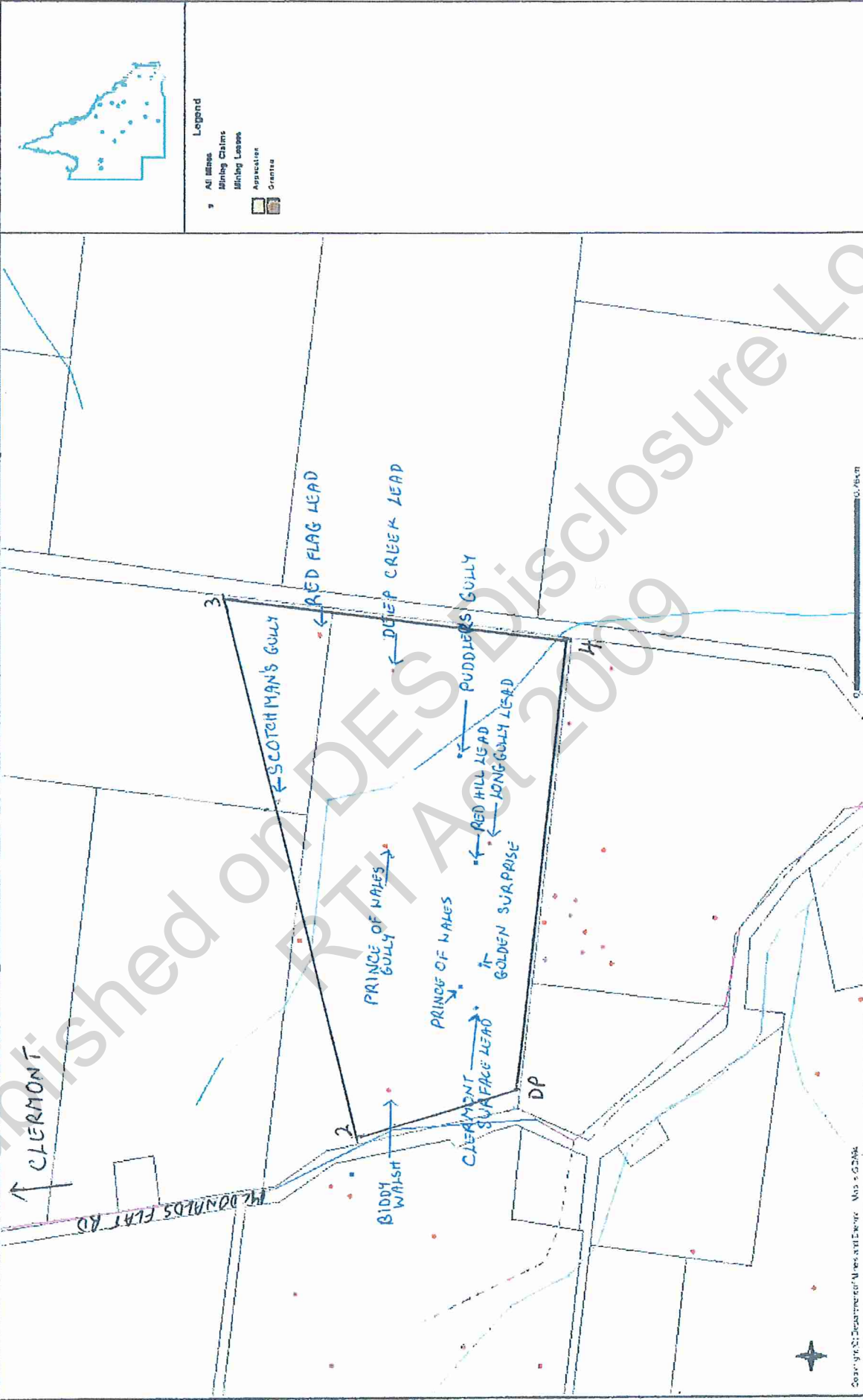

Source: IRTM, Department of Mines and Energy, Map # 02046

Queensland Department of Mines and Energy 2008. While every care is taken to ensure the accuracy of this product, the Department of Mines and Energy makes no representations or warranties about its accuracy, reliability, completeness or suitability for any particular purpose and disclaims all responsibility and all liability (including without limitation, liability in negligence) for all expenses, losses, damages (including indirect or consequential damage) and costs which you might incur as a result of the product being inaccurate or incomplete in any way and for any reason.

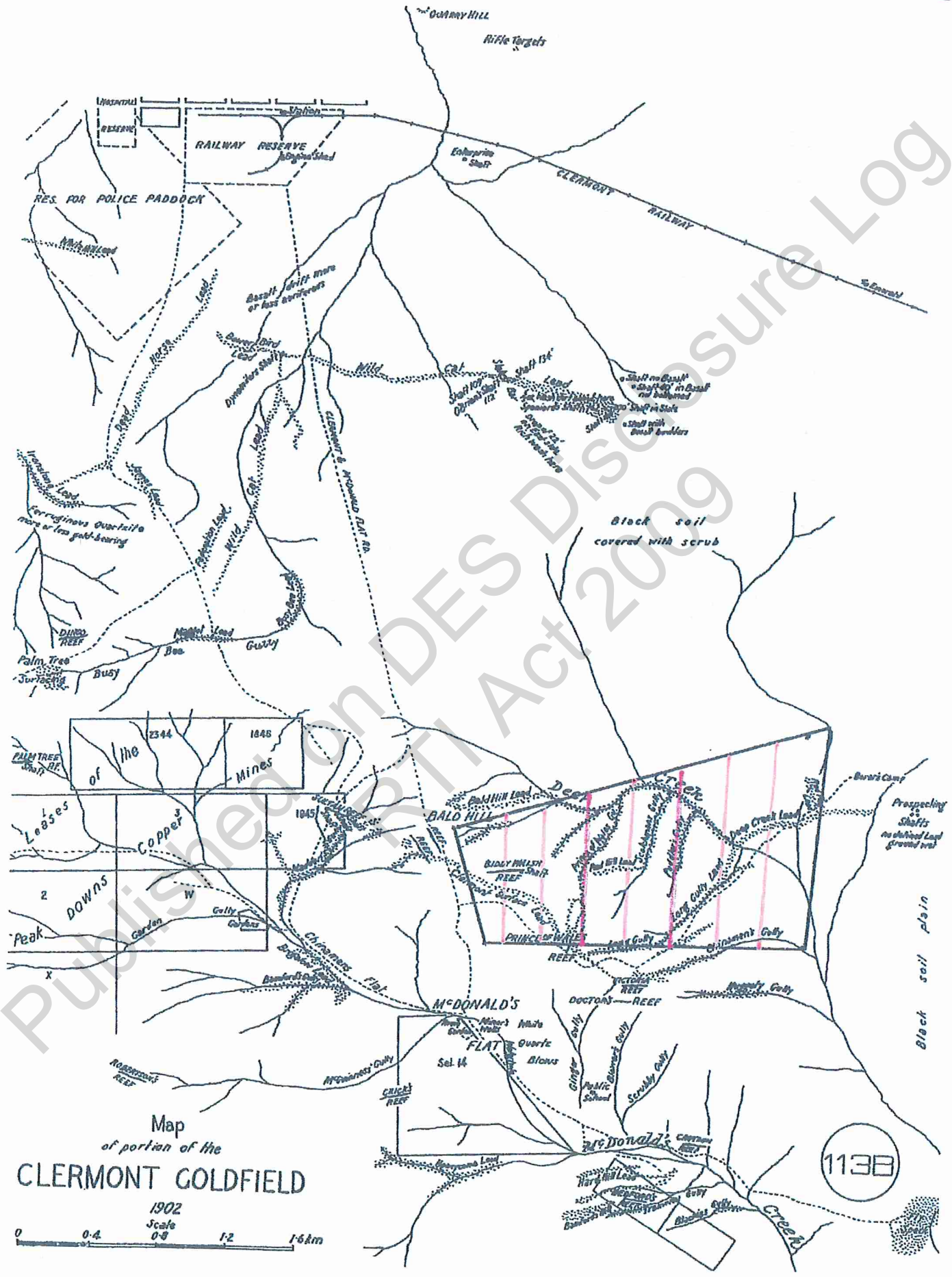

Map
of portion of the
CLERMONT GOLDFIELD
1902
Scale
0-4 0-8 1-2 1-6 km