



QUEENSLAND

No. 842  
Reg. Mareeba  
Vol. 428  
Fol. 78

MINERS' HOMESTEAD LEASES ACT 1913-1979

Miner's Homestead Perpetual Lease

MINING FIELD: Mareeba  
COUNTY: Nares  
PARISH: Tinaroo  
AREA: 1012 m<sup>2</sup>  
DATE OF LEASE: 28th July, 1983.

ELIZABETH THE SECOND,  
by the Grace of God, Queen  
of Australia, and Her other  
Realms and Territories, Head  
of the Commonwealth.

To All to whom these Presents shall come, Greeting:

WHEREAS in conformity with the Miners' Homestead Leases Act 1913-1979, hereinafter called "the said Act", JOSEPH FALVO

, in Our State of Queensland, is now entitled to a Lease in Perpetuity of the Land hereunder particularly described as a Miner's Homestead Perpetual Lease at the rent and under and subject to the covenants, terms, and conditions hereinafter mentioned: NOW KNOW YE that in consideration of the premises, WE DO HEREBY, for Us, Our Heirs and Successors, demise and lease unto the said JOSEPH FALVO

(hereinafter designated

"the Lessee ") and his executors, administrators, and permitted assigns, all that piece of Land in Our said State, containing by admeasurement One thousand and twelve square metres be the same more or less, situated in the Mining Field of Mareeba, being Lease Number Eight hundred and forty-two on the Warden's register:—

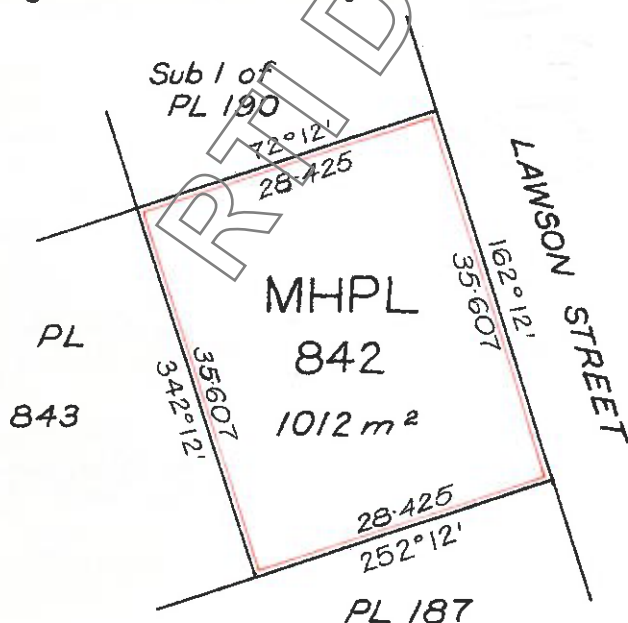

Being Lot No. 1 cancelling part of MHPL 186 and as shown on the adjoining diagram and plan catalogue number 33127 held at the Department of Mines, Brisbane

TO HAVE AND TO HOLD unto the Lessee, his executors, administrators, and permitted assigns, in perpetuity, as a Miner's Homestead Perpetual Lease as from the Eighth day of June One thousand nine hundred and eighty-three, with, under, and subject to the reservations hereinafter particularly mentioned, and with, under and subject to the several rights,

Form No. 22

powers, privileges, terms, conditions, provisions, exceptions, restrictions, reservations, and provisos contained or implied in Section 24 of the said Act, and to all other rights, powers, privileges, terms, conditions, provisions, exceptions, restrictions, reservations, and provisos referred to, contained, or prescribed in and by the said Act and the *Mining Act* 1968-1980, and the *Petroleum Act* 1923-1981, or any Regulations made or which may hereafter be made under the said Act, or any of them: YIELDING AND PAYING unto Us, Our Heirs and Successors, in each and every year during the first Ten years of the Lease hereby granted, the annual rent of Sixteen \_\_\_\_\_ dollars eighty \_\_\_\_\_ cents:

AND in each and every year, during each succeeding period of Ten years, an annual rent equal to that payable for the period then last expired, or (if application shall have been made by the lessee or the Minister at least six months prior to the expiration of the then current period in accordance with the provisions of said Act) such annual rent as shall thereupon have been determined by the Warden; such payments to be made in advance, and on or before the Thirty-first day of December in each and every year, into the hands of the Warden of the Mining Field in which the Miner's Homestead comprised in the said Lease is situated.

PROVIDED ALWAYS, and We do hereby reserve unto Us, Our Heirs and Successors, all gold and minerals (the term "Minerals" to have the same meaning as in the *Mining Act* 1968-1980) and all petroleum (the term "Petroleum" to have the same meaning as in the *Petroleum Act* 1923-1981) and all helium found in association with petroleum on or below the surface of the said Land, and all mines of gold and minerals on or below the surface of the said Land, and We do hereby also reserve unto Us, Our Heirs and Successors, and to such persons as shall from time to time be duly authorised by Us in that behalf at all times, the free right and privilege of access, including ingress, egress, and regress, into, upon, over, and out of the said Land, for the purpose of searching for or working gold and minerals, or any of them, or mines of gold and minerals, or any of them, and of searching for, and for the operations of obtaining and conveying petroleum, in, on and over any part of the said Land: AND We do further reserve the right of any person duly authorised in that behalf by the Governor of Our said State in Council at all times to go upon the said Land, or any part thereof, for any purpose whatsoever, or to make any survey, inspection, or examination of the same.

IN TESTIMONY WHEREOF, We have caused this Our Lease to be Sealed with the Seal of Our said State.

WITNESS *Our Trusty and Well-beloved His Excellency Commodore SIR JAMES MAXWELL RAMSAY, Knight Commander of the Most Distinguished Order of Saint Michael and Saint George, Knight Commander of the Royal Victorian Order, Commander of the Most Excellent Order of the British Empire, upon whom has been conferred the Decoration of the Distinguished Service Cross, and Commodore in the Royal Australian Navy (Retired), Governor in and over the State of Queensland and its Dependencies in the Commonwealth of Australia, at Government House, Brisbane, in Queensland aforesaid, this twenty-eighth day of July in the thirty-second year of Our Reign, and in the year of Our Lord One thousand nine hundred and eighty-three.*

s.49 - Signature

ENDORSEMENTS

79  
Mortgage No. 12/79  
Registered at the Warden's Office Mareeba this 12th day of April 1979  
Sgd. H.T. Spicer Warden  
Joseph Falvo to  
Bank of New South Wales

I hereby certify that I have this day recorded the undermentioned transfer.  
Dated at Mareeba 21st day of November 1983  
s.49 - Signature [Redacted] Warden.  
The Miner's home [Redacted] he within written lease.  
Date of Approval 2.11.83.  
Transferor Joseph FALVO.  
Victorio Giovanni TIRABOSCHI  
and Santina Maria TIRABOSCHI  
as joint tenants.

Mortgage No. 34 / 19 83 - MAREEBA  
Registered Warden's Office, Mareeba this 21st day of November 1983.  
s.49 - Signature [Redacted]  
H.T. Spicer  
Mortgagor: Victorio TIRABOSCHI  
and Santina TIRABOSCHI  
Mortgagee: Australia and New Zealand Banking Group Limited.

RTI Disclosure Log

**ENDORSEMENTS**

RTI Disclosure Log

12970/10/81—2M—P/L—Govt. Printer, Qld.



47 11



Department of Mines

Warden's Office

22 NOV 1982

P.O. Box No. 182

MAREEBA

Qld. 4880

921687

RECEIVED 5th November, 1982  
SURVEY BRANCH  
22 NOV 1982  
DEPT. OF MINES QUEENSLAND

The Director-General,  
Department of Mines,  
G.P.O. Box 194,  
BRISBANE. Q. 4001.

33127

Dear Sir,

Re: M.H.P.L. No. 186 - Mareeba.

s.49 - Signature

I have to advise that on the 1st November, 1982, the lessee of the above homestead made application to subdivide same.

I now forward herewith the following documents:

1. Application to Subdivide;
2. Request for the Issue of New Instruments of Lease;
3. Plan of Survey, and
4. Instrument of Lease.

The following fees were collected and will be remitted to your office with my collections for the month of November, 1982:

1. Duplicate Plan Fee of \$5;
2. Examination Fee 2 @ \$11.50;
3. Application to Subdivide 2 @ \$6.75, and
4. Application for Issue of New Instruments 2 @ \$8.40.

The following numbers have been allocated at this office with respect to each lot:

Lot 1 on Plan - 842 : Lot 2 on Plan - 843.

Please advise in due course when the subdivision has been approved.

See folio 418  
for R.M.T.

s.49 - Signature

22 NOV 1982

Yours faithfully,

s.49 - Signature

H.T. Spicer  
Warden.

Plan must be drawn within blue lines

33127

33127

NO. FILED NOTICES FORWARDED	RECEIVED	DRAWN	CHARTED UPWARD
	22 11 82	16 8 82	
EXAMINED	CHECKED	LOCALITY	
		Mareeba	
MAP REFERENCE	PROC SURVEY AREA		

PLAN OF  
MINING FIELD  
SURVEYED BY  
D.A. Michael  
6 8 82

6 17 82  
DOWNNS  
MHL 197  
1250  
Lots 1 and 2  
cancelling MHPL 186 on MP 03434  
PARISH TINAROO  
COUNTY Nares  
MINING DISTRICT Mareeba  
MERIDIAN  
SCALE 1 : 800  
MP 03434

Cal. No. 33127  
DEPARTMENT OF MINES QUEENSLAND

Filed 1.11.82  
No. 2/6.80  
870139  
s.49 -  
Signature

MINERS' HOMESTEAD LEASES ACT 1913-1976

REQUEST FOR THE ISSUE OF NEW INSTRUMENTS OF LEASE

I/we, JOSEPH FALVO \_\_\_\_\_,

of 14 Lawson Street, Mareeba \_\_\_\_\_,

in the State of Queensland, being the Lessee/s of Miner's Homestead No. 186 on the Mining Field of Mareeba,

do hereby apply to the Minister, pursuant to Section 28 (2)(c) of the Miners' Homestead Leases Act 1913-

1976, for the issue of an Instrument of Lease in respect of each of the proposed Lots 1 and 2 cancelling the above Miner's Homestead as shown on plan of survey tendered herewith.

Dated this 28<sup>th</sup> day of October, 1982.

Signed by the said JOSEPH )  
FALVO \_\_\_\_\_ )

in the presence of  
s.49 - Signature

A Justice of the Peace.

RTI Disclosure Log

1.11.82  
EXAM FEE 8.33.00  
APPLN SUB 7.13.00  
SUR. RAY FEE 85.00  
870139

s.49 -  
Signature

**Application to Subdivide Miner's Homestead Lease**  
(Reg. 16)

I, Joseph FALVO  
of 14 Lawson Street, Mareeba  
in the State of Queensland, being the Lessee of Miner's Homestead No. 186 on the  
Mining Field of Mareeba within the Mining District of Mareeba  
hereby apply to the Minister for approval to subdivide the said Miner's Homestead as shown on  
the Plan of Survey tendered herewith.

Dated this 28th day of October, 1982.

Signed by the said  
**JOSEPH FALVO**

Signed:

s.49 - Signature

in the presence of—

s.49 - Signature

A Justice of the Peace.

RTI Disclosure Log

DESCRIPTION PROFORMA

Miner's Homestead Perpetual Lease

MINING FIELD: Marceba ✓
COUNTY: Nares ✓
PARISH: Tinaron ✓
AREA: 1012 m² ✓

No. 842 ✓
Reg. Marceba ✓

To All to whom these Presents shall come, Greeting:

WHEREAS in conformity with the Miners' Homestead Leases Act 1913-1978, hereinafter called "the said Act", JOSEPH FALVO ✓

in Our State of Queensland is now entitled to a Lease in Perpetuity of the Land hereunder particularly described as a Miner's Homestead at the rent and under and subject to the covenants, terms, and conditions hereinafter mentioned: NOW KNOW YE that in consideration of the premises, WE DO HEREBY, for Us, Our Heirs and Successors, demise and lease unto the said JOSEPH FALVO ✓

(hereinafter with — successors in title designated "the Lessee") and his executors, administrators, and assigns, all that piece of Land in Our said State, containing by admeasurement One thousand and twelve square metres ✓

be the same more or less, situated in the Mining Field of Marceba ✓, being Lease Number Eight hundred and forty-two on the Warden's register:—

Being lot No 1 cancelling part of M.H.P.L. 186 and as shown on the adjoining diagram and plan catalogue number 33127 ✓ held at the Department of Mines, Brisbane

TO HAVE AND TO HOLD unto the Lessee, his executors, administrators and assigns, in perpetuity, as a Miner's Homestead as from the Eighth day of June, One thousand nine hundred and eighty-three, with, under, and subject

to the reservations hereinafter particularly mentioned, and with, under, and subject to the several rights, AND PAYING unto Us, Our Heirs and Successors, in each and every year during the first Thirty years of the Lease hereby granted, the annual rent of sixteen dollars and eighty cents ✓

Noted ...
Checked ...
Date: 29-6-03

Vol. 428
Fol. 78
Cat. No. 33127





Department of Mines,  
Mineral House,

41-59 George Street,  
Brisbane, 4000

2

Your Ref. ....  
Our Ref. ....

Postal Address:  
G.P.O. Box 194 Brisbane, 4001  
Telephone: 224 0414  
Telux No.: 43040

**MEMORANDUM:**

10th June, 1983

Re: **Application to Subdivide MHL No. 186 Mareeba**

With reference to your letter of 15th November, 1982, I have to inform you that the plan of survey of the above subdivision has been passed correct in respect of the following areas:-

<u>Lot No.</u>	<u>Lease No.</u>	<u>Area</u>
1	842	1012 square metres
2	843	1011 square metres

Pursuant to Section 28 of the Miners' Homestead Leases Act, 1913-1982, the following was approved on 8th June, 1983 :-

- (i) the application to subdivide Miner's Homestead Lease No. 186 on Plan Cat. No. 33127 ; and , as delineated
- (ii) the cancellation of Miner's Homestead Lease No. 186 on issue of the new Instruments of Lease.

As from 1st January next, the annual rental on these Homesteads will be:-

<u>Lease No.</u>	<u>Capital Value</u>	<u>Ann. Rental</u>
842	\$1120	\$16.80
843	\$1120	\$16.80

The Instruments of Lease of the new Homesteads will now be prepared and further advice will follow.

D DG Mines  
**LEASE PREPARED**  
s.49 -  
S  
g  
nature  
21-7-83

s.49 - Signature

**J. WOODS,**  
**Director-General.**

The Warden,  
Court House,  
MAREEBA. 4880

APPROVED

3

der Secretary,  
ment of Mines,

Warden's Office,

s.49

2 NOV 1983

natu  
re

Department of Mines

MAREEBA. Q. 4880.

19 OCT 1983

RECEIVED IN RECORDS  
14 NOV 1983

5th October 1983.

"The Miners' Homestead Leases Act 1913 - 1976"

I have the honour to report the undermentioned transfer and to recommend its approval..... by the Minister.

Transferee ~~is~~ are ..... a Qualified Person under the Act.

s.49  
Signature

s.49 - Signature

H.T. Spicer  
Warden

WARDEN ADVISED  
10 NOV 1983

② Noted + correct  
Copy to V... General

s.49 -  
S  
Signature

2 NOV 1983

Perpetual Lease

Miners' Homestead ~~xxx~~ application No. 842 - Mareeba.

Transferror Joseph FALVO.....

Transferee Vittorio Giovanni TIRABOSCHI and Santina Maria TIRABOSCHI (full name) as joint tenants.

Date of Transfer 14th May, 1983.....

Date received at Warden's Office 27th September, 1983..

Rent paid to 31st December, 1983.....

Fees paid \$5.50.. R. 880986.....

N.B. - Report to be furnished in duplicate.

M. 121

WARNING—Folding or mutilating will lead to rejection—plan may be rolled

PERMANENT MARKS

PM	Bearing	Distance	Number
1-OPM	249°08'50"	3.266	58

REFERENCE MARKS

Stn	To	Bearing	Distance
1	OIP	220°56'	1.177
2	"	252°12'	1.025
3	"	"	1.058
4	"	"	1.006
5	Can Steel R.F.F.	27°06'	0.05
6	OIP	252°12'	1.006
7	Can Steel R.F.F.	165°48'	0.33
8	OIP	248°12'	1.006
9	OIP	342°12'	0.453
10	OIP	76°12'	1.006
11	Can Steel R.F.F.	25°15'	0.27
12	Can Steel R.F.F.	4°12'	0.28
13	Can Steel R.F.F.	89°07'	0.35
14	Can Steel R.F.F.	54°04'	0.27
15	Can Steel R.F.F.	44°04'	0.27
16	Can Steel R.F.F.	72°12'	1.0
17	Can Steel R.F.F.	49°21'	0.323
18	Can Steel R.F.F.	208°50'	0.395
19	"	278°04'	0.27
20	"	208°24'	0.27

TRAVERSES

Line	Bearing	Distance
6-7	162°12'	20.12

TENURE

Lot	New MHPL	MTFL
1	842	30
2	843 F/H Lot 45 42	

Partly covered by MP 34530  
Partly covers MP 03434

NO FIELD NOTES LODGED					LINES NOT SURVEYED		STNS		CORNERS NOT MARKED		STNS	
INSTR No.	RECEIVED	DRAWN	CHARTED	DUP/WARD	<b>PLAN OF</b>							
	22-11-82	MAM 15-8-82	R.C. 15-8-82	22-8-82	Lots <b>1 and 2</b>							
EXAMINED					LOCALITY		MINING FIELD		PARISH <b>TINAROO</b>			
CHECKED					Mareeba		MAREEBA		COUNTY <b>Nares</b>			
D.R.C.									MINING DISTRICT <b>Mareeba</b>			
25-5-83												
MAP REFERENCE		PROC SURVEY AREA		SURVEYED BY		MERIDIAN		SCALE		Cat.No. <b>33127</b>		
TOWN OF MAREEBA		SH.2		D.R. Michael		MP. 03434		1:800				
				6.1.82								

CROWN COPYRIGHT RESERVED

Plan must be drawn within blue lines

Plan must be drawn within blue lines

33127

33127

33127

33127

CIS



33127

33127

33127

33127

CERTIFICATE

I, Donald Robert Michael  
hereby certify that Michael Patrick Dillon surveyed the land  
comprised in this plan for whose work I accept  
responsibility

that the plan is accurate, that the said survey was performed in  
accordance with the 'Surveyors Act 1977-1978' and the 'Surveyors  
Regulations 1978' and that the said survey was completed on  
6.8.82

s.49 -  
S  
ig

Signature of Licensed Surveyor

Date 19/8/82

RECEIVED  
SURVEY BRANCH  
22 NOV 1982  
DEPT. OF MINES QUEENSLAND

For Additional Plan &  
Development Stamp  
Refer to CIP

Council of the SHIRE of MAREEBA

certifies that all the requirements of this Council, the Local  
Government Acts of 1986 to 1981 and all By-Laws have been  
complied with and approve this Plan of Subdivision

Dated this Twentieth day of September 19 82

s.49 - Signature

~~Chairman~~

~~Shire Clerk~~

I/We JOSEPH FALVO

as lessee(s) of Miners Homestead

agree to this plan of subdivision

Signature (s) of lessee(s)

s.49 -  
S  
ignature

RTI Disclosure Log